

ACCESS

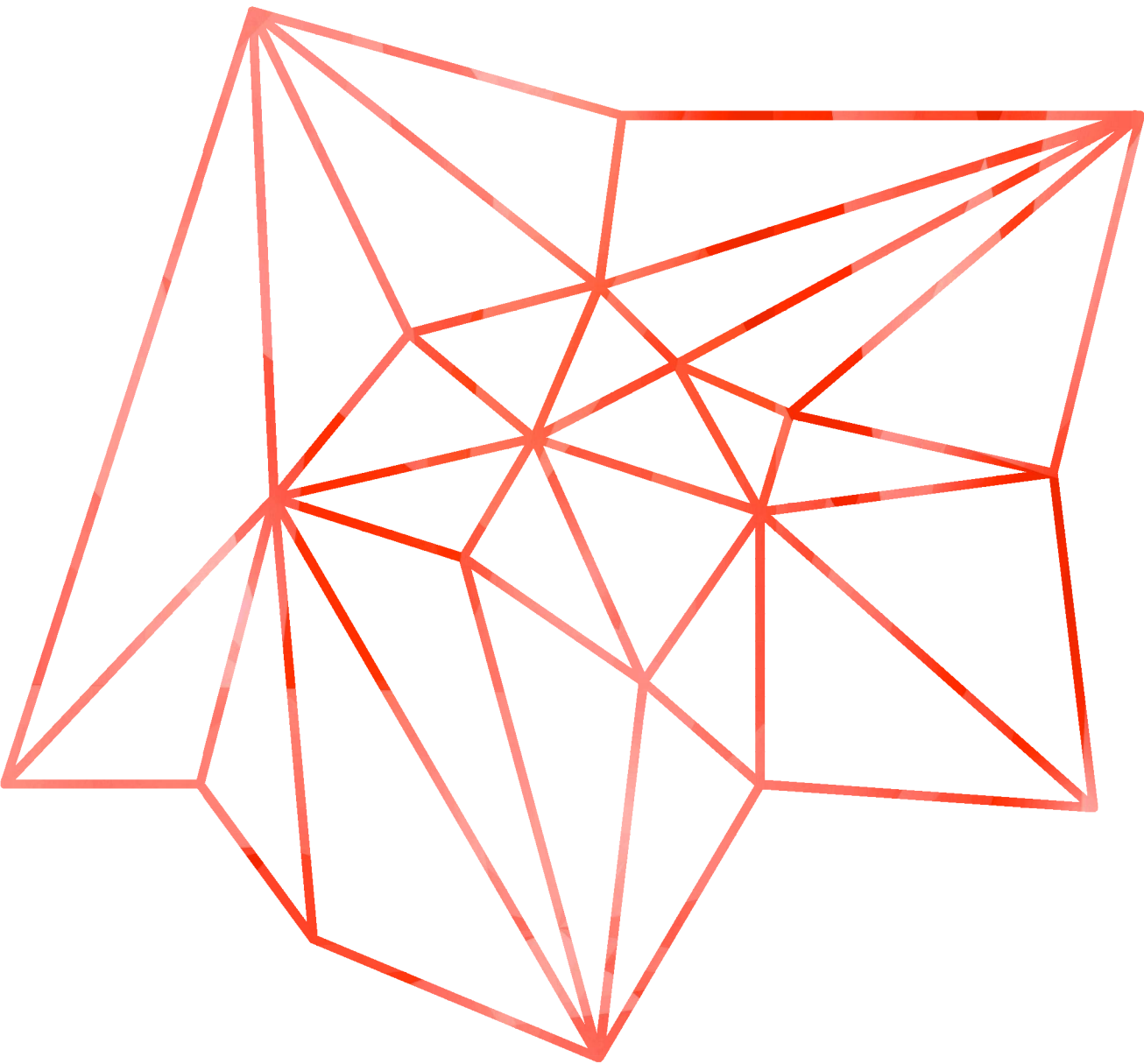

ACCESS

SÓRIES

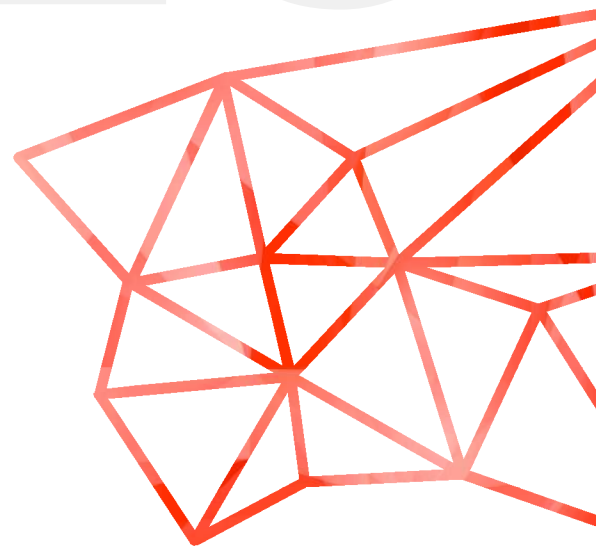

**06**

**ACESSÓRIOS**  
*ACCESSORIES*

SÓRIOS



- 
- 168** **ACESSÓRIOS PARA VITRINES**  
*ACCESSORIES FOR SHOWCASES*
- 182** **CALHAS, CREMALHEIRAS, SUPORTES E ACESSÓRIOS**  
*SLIDING DOOR TRACKS, RACKS, SUPPORTS, BRACKETS  
AND ACCESSORIES*
- 194** **ACESSÓRIOS PARA EQUIPAMENTOS REFRIGERADOS**  
*ACCESSORIES FOR REFRIGERATED EQUIPMENTS*
- 198** **ACESSÓRIOS PARA ESPAÇOS DE CONSERVAÇÃO  
E PREPARAÇÃO DE ALIMENTOS**  
*ACCESSORIES FOR STORAGE AND FOOD PREPARATION AREAS*
- 209** **TUBOS E VÁLVULAS DE ESGOTO**  
*DRAIN TUBES AND VALVES*
- 211** **FECHOS E FECHADURAS**  
*LATCHES AND LOCKS*
- 218** **PERFIS DE PLÁSTICO E BORRACHA**  
*PLASTIC AND RUBBER PROFILES*
- 224** **SUPORTES, BASES, LIGAÇÕES E REMATES DE TUBO**  
*TUBE SUPPORTS, MOUNTING BASES, CONNECTORS  
AND END CAPS*
- 229** **CLIPS PARA VIDRO**  
*GLASS CLAMPS*
- 231** **EMBELEZADORES**  
*COVERS*

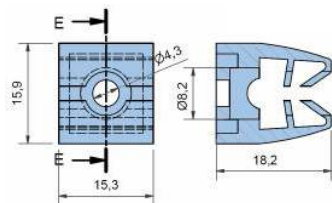

### AC.1083

Suporte em polipropileno(PP) cinza para sonda de termostato

*Grey polypropylene(PP) support for thermostat probe*

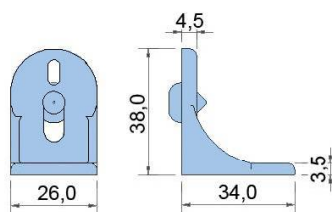

### AC.1009 G

Suporte grande em policarbonato(PC) transparente para vidro de vitrine

**AC.1021** Incluído

*Large transparent polycarbonate(PC) support for showcase glass*

*AC.1021 Included*

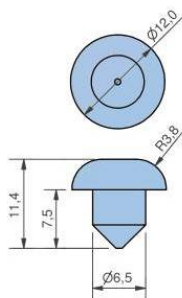

### AC.1021

Piton em PVC transparente para AC.1009 G

*Transparent PVC stud for AC.1009 G*

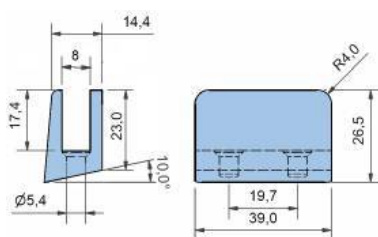

### AC.1010 - AC.1010 C

Suporte inclinado em poliamida (PA) para vidro de vitrine

*Slanted polyamide (PA) support for showcase glass*

- AC.1010** - Preto / Black
- AC.1010 B** - Branco / White
- AC.1010 C** - Cinza / Grey

Outras cores sob consulta  
*Other colours upon request*

## AC.1011 - AC.1011 B

Suporte direito em poliamida (PA) para vidro de vitrine

*Straight polyamide (PA) support for showcase glass*

**AC.1011** - Preto / *Black*  
**AC.1011 B** - Branco / *White*  
**AC.1011 C** - Cinza / *Grey*

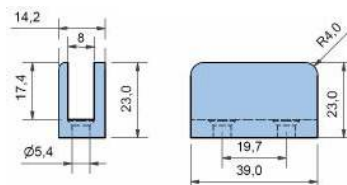

 Outras cores sob consulta  
*Other colours upon request*

## AC.1077

Suporte inclinado em policarbonato (PC) para vidro de vitrine

*Slanted transparent polycarbonate (PC) support for showcase glass*

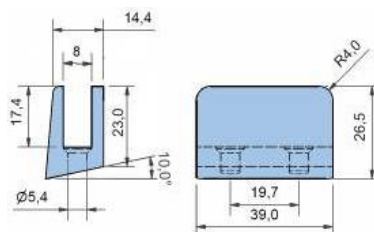

## AC.1078

Suporte direito em policarbonato (PC) para vidro de vitrine;

*Straight transparent polycarbonate (PC) support for showcase glass*

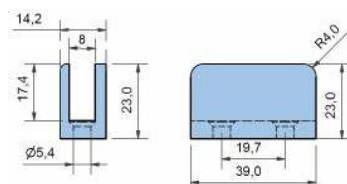

## AC.1533

Suporte em poliamida (PA) preto para vidro de vitrine

*Straight black polyamide (PA) support for showcase glass*

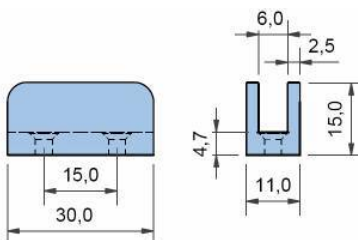

 Outras cores sob consulta  
*Other colours upon request*



### AC.1012

Ligação dupla em latão niquelado para vidro  
(inclui casquilhos e parafusos de inox)

*Nickel-plated brass double joint for glass  
(includes bushings and stainless steel screws)*



### AC.1612

Ligação dupla em latão niquelado para vidro

*Nickel-plated brass double joint for glass*

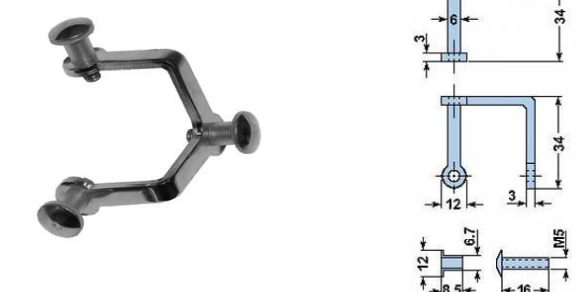

### AC.1013

Ligação tripla em latão niquelado para vidro  
(inclui casquilhos e parafusos de inox)

*Nickel-plated brass triple joint for glass  
(includes stainless steel bushings and screws)*



### AC.1613

Ligação tripla em latão niquelado para vidro

*Nickel-plated brass triple joint for glass*

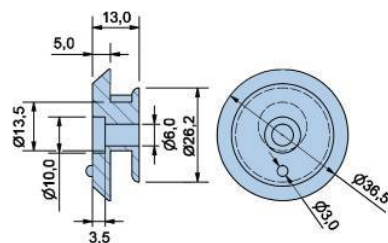

### AC.1018 - AC.1018 B

Excêntrico em poliamida (PA) para vitrine

*Polyamide (PA) eccentric support for showcase glass*

**AC.1018** - Preto / Black  
**AC.1018 B** - Branco / White



### AC.1019 - AC.1019 B

Excêntrico em poliamida (PA) para vitrine

*Polyamide (PA) eccentric support for showcase glass*

**AC.1019** - Cinza / Grey  
**AC.1019 B** - Branco / White



## AC.1020

Excêntrico em poliamida (PA) preto para fecho de vidro frontal de vitrine

*Black polyamide (PA) eccentric support to connect showcase glass*

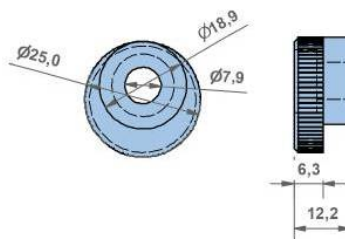

## AC.1535

Suporte em poliamida (PA) cinza para vidro

*Grey polyamide (PA) support for glass*

### AC.1535-1

Suporte em policarbonato (PC) transparente para vidro

*Transparent polycarbonate (PC) support for glass*

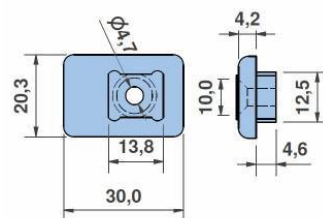

## AC.1044

Parafuso M10x10mm em poliamida (PA) preta

*M10x10mm black polyamide (PA) screw*

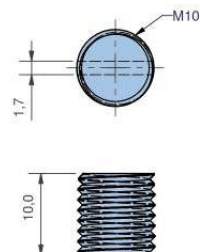

## AC.1053

Conjunto de parafuso M5x20mm e porca em inox com casquilho para ligação de vidro

*Stainless steel M5x20 screw and nut with bushing for glass connection*

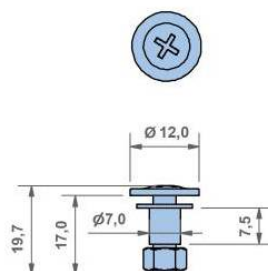

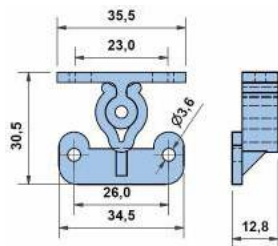

### AC.1058 PA

Fecho em poliamida (PA) cinza para portas, gavetas e armários

*Grey polyamide (PA) snap latch for drawers, doors and cabinets*

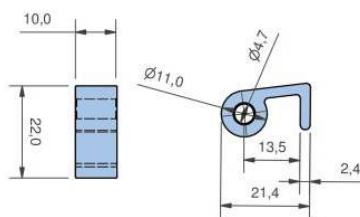

### AC.1061

Gancho em acetal branco para vidro de vitrine

*White acetal hook for showcase glass*

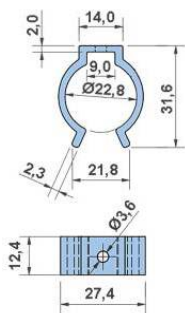

### AC.1062

Suporte em acetal branco para lâmpada

*White acetal support for lamp*

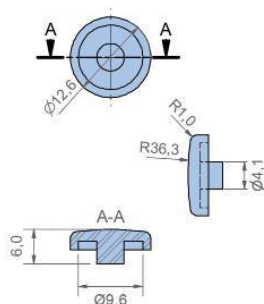

### AC.1080 - AC.1080 CA

Tampão em poliamida (PA) para rebite de 4mm

*Polyamide (PA) cap for 4mm rivet*

**AC.1080** - Branco / *White*

**AC.1080 C** - Cinza / *Grey*

**AC.1080 CA** - Castanho / *Brown*

## AC.1081 - AC.1081 P

Tapa furos em poliamida (PA)

*Polyamide (PA) hole cover*

- AC.1081** - Branco / *White*
- AC.1081 C** - Cinza / *Grey*
- AC.1081 CA** - Castanho / *Brown*
- AC.1081 P** - Preto / *Black*

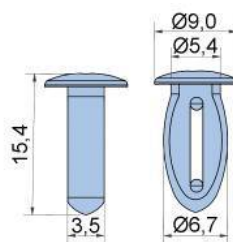

## AC.1214

Ligação dupla em latão niquelado para vidro  
(inclui duas anilhas em PVC transparente)

*Nickel-plated brass double joint for glass  
(includes 2 transparent PVC washers)*

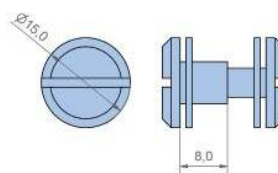

## AC.1215

Par de dobradiças em inox para tampa de vitrine  
Fornecido com parafusos e porcas

*Lid cover bracket assembly  
Supplied with pivot screws and pins*

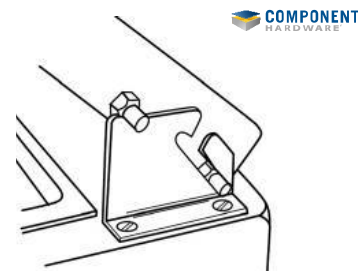
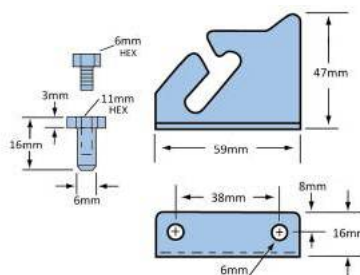

**EXEMPLO DE APLICAÇÃO**  
**EXAMPLE OF APPLICATION**

 **COMPONENT**  
HARDWARE

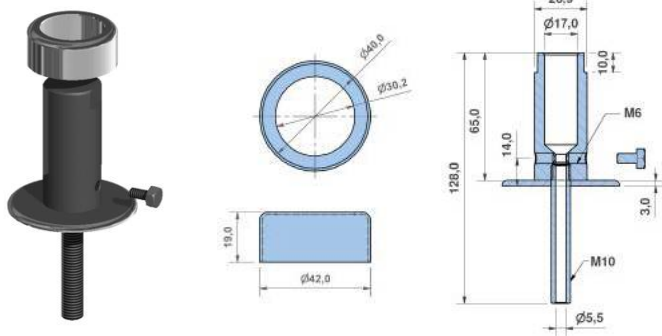

### DV.2650

Kit base suporte Ø60x128mm  
(permite a passagem de um cabo por dentro)

Support base kit Ø60x128mm  
(allows passage of one cable inside)

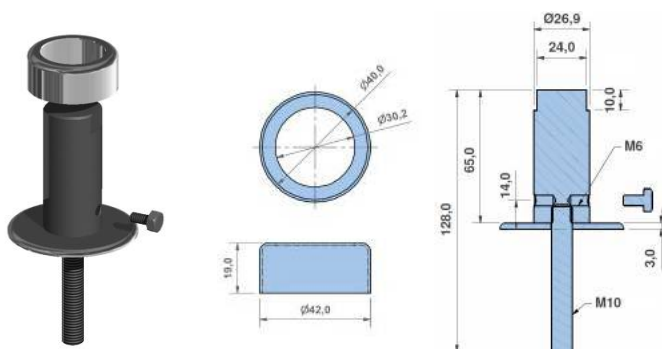

### DV.2651

Kit base suporte Ø60x128mm

Support base kit Ø60x128mm

174

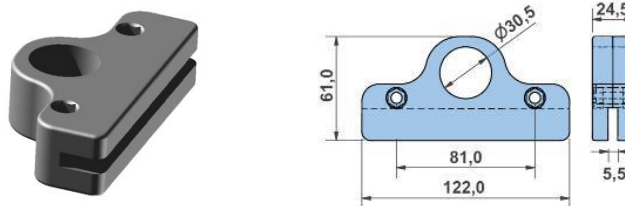

### AC.1265 - AC.1265 P

Suporte de self em poliamida (PA) para vidro de vitrine  
Espessura vidro 6/8mm

Polyamide (PA) support for showcase glass  
6/8mm glass thickness

AC.1265 - Cinza / Grey  
AC.1265 P - Preto / Black

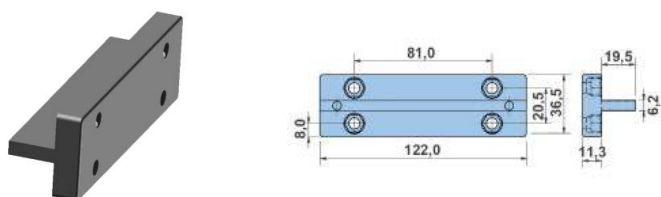

### AC.1266 - AC.1266 P

Suplemento de self em poliamida (PA) para AC.1265

Polyamide (PA) supplement for AC.1265

AC.1266 - Cinza / Grey  
AC.1266 P - Preto / Black

## AC.1267 - AC.1267 P

Suporte/ligação de self em poliamida (PA) para vidro de vitrine

Espessura vidro 6/8mm

*Polyamide (PA) connection/support for showcase glass  
6/8mm glass thickness*

**AC.1267** - Cinza / Grey

**AC.1267 P** - Preto / Black

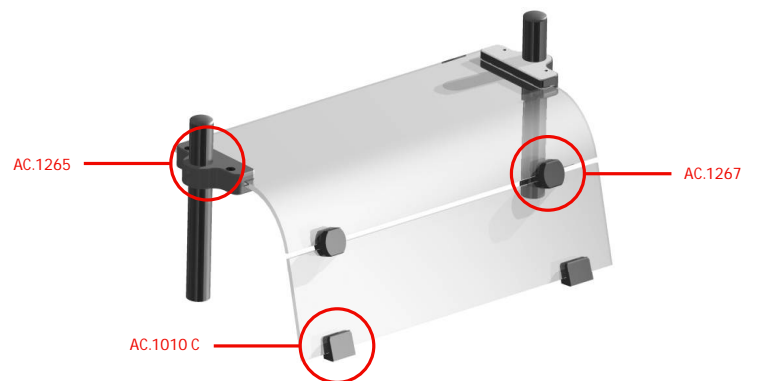
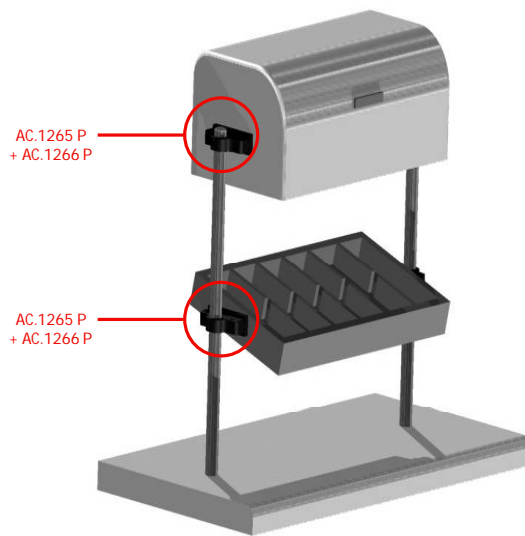
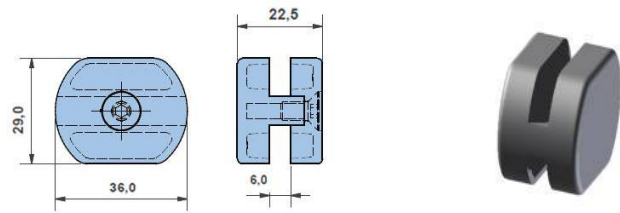

**EXEMPLO DE APLICAÇÃO**  
*EXAMPLE OF APPLICATION*

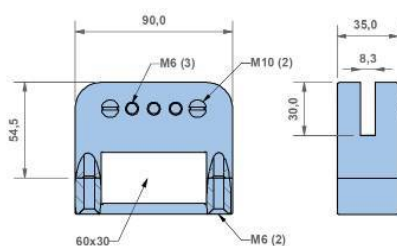
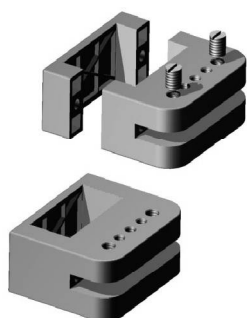

### AC.1269-1 - AC.1269-1 P

Suporte de self em poliamida (PA) para vidro de vitrine  
Espessura vidro 8mm

*Polyamide (PA) support for showcase glass  
8mm glass thickness*

**AC.1269-1** - Cinza / Grey  
**AC.1269-1 P** - Preto / Black

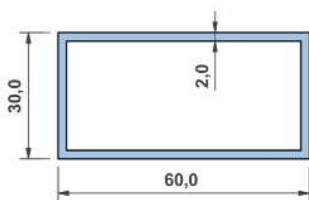
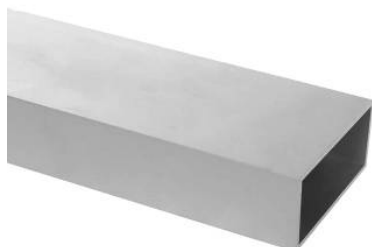

### AC.1286

Perfil de alumínio anodizado cinza 60x30x2 com 5,8mt

*Grey anodized aluminium profile 60x30x2 with 5,8mt*

176

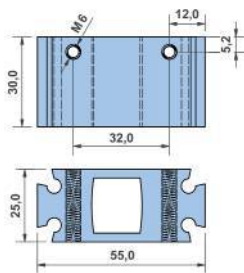

### AC.1287

Base suporte de prumo em alumínio

*Aluminium support base for profile*

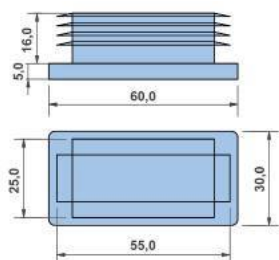

### TC.6030 Z C

Tampão plástico cinza 60x30mm

*Grey plastic cap for rectangular tube 60x30*

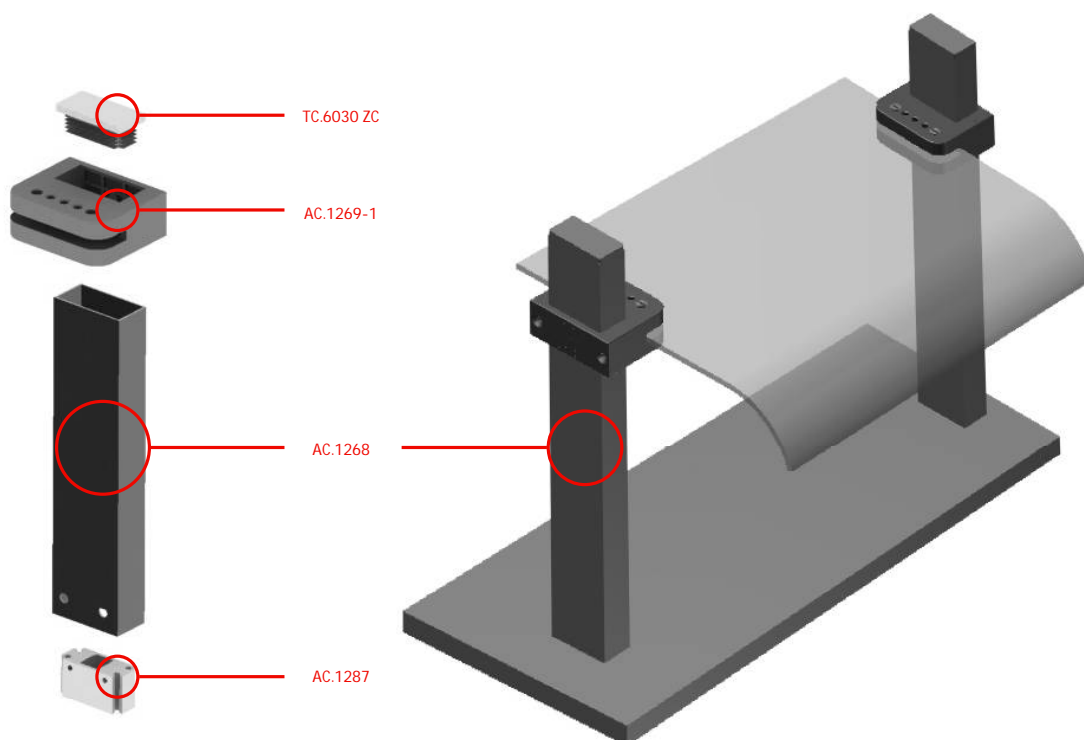

**MONTAGEM DA BASE SUPORTE**  
ASSEMBLY OF BASE SUPPORT

**EXEMPLO DE APLICAÇÃO**  
EXAMPLE OF APPLICATION

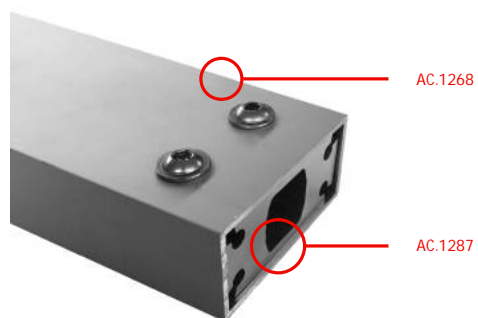

**FIXAÇÃO DA BASE AO PERFIL**  
APPLICATION OF BASE ON PROFILE

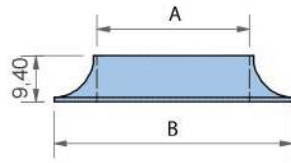

### EP.C.01.30.PN - EP.C.01.38.PN

Base em poliamida (PA) preta para remate de tubo redondo

*Black polyamide (PA) base for finishing round tube*

	ØA	ØB
EP.C.01.30.PN	30	47
EP.C.01.38.PN	38	55

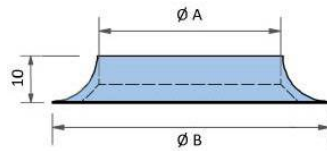

### DV.2860 - DV.2061

Base em inox para remate de tubo

*Stainless steel finishing for tube*

	ØA	ØB
DV.2860	38.2	58.0
DV.2061	60.5	80.0

178

Outras medidas sob consulta  
*Other dimensions upon request*

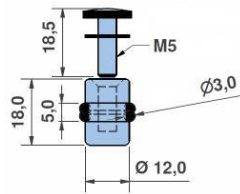

### AC.1270

Acessório em latão cromado com parafuso para aplicar em vidro

*Chrome plated brass accessory with screw for application on glass*

Opção: inox sob consulta  
*Option: stainless steel upon request*

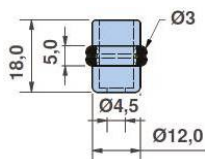

### AC.1271

Acessório em latão cromado sem parafuso para aplicar em vidro

*Chrome plated brass accessory without screw for application on glass*

Opção: inox sob consulta  
*Option: stainless steel upon request*



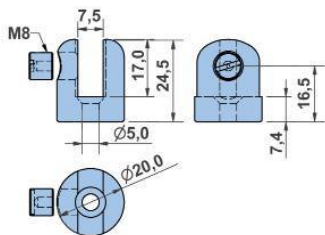

### AC.1277

Acessório em latão cromado Ø20mm com rasgo de 7,5mm para aplicar em vidro

*Chrome plated brass Ø20mm accessory with a 7,5mm opening for application on glass*

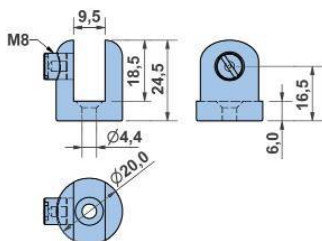

### AC.1278

Acessório em latão cromado Ø20mm com rasgo de 9,5mm para aplicar em vidro

*Chrome plated brass Ø20mm accessory with a 9,5mm opening for application on glass*

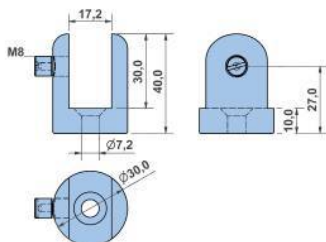

### AC.1279

Acessório em latão cromado Ø30mm com rasgo de 17mm para aplicar em vidro

*Chrome plated brass Ø30mm accessory with a 17mm opening for application on glass*

## PT.1300 - PT.1305

Porta em ABS para vitrine com perfil em PVC com magnético  
Fornecida com dobradiças e fiéis

**Opção: Fecho AC.1059**

*ABS showcase doors with PVC gasket with magnet  
Supplied with hinges and pins*

**Option: Latch AC.1059**

**PT.1300** – Cinza claro / *Light grey*  
**PT.1301** – Cinza escuro / *Dark grey*  
**PT.1304** – Branca / *White*

Outras cores sob consulta  
*Other colours upon request*



**EXEMPLO DE APLICAÇÃO**  
*EXAMPLE OF APPLICATION*



**DOBRADIÇA**  
*HINGE*

**PEGA**  
*PULL*



**PORTA**  
*DOOR*



**INTERIOR PORTA**  
*DOOR INTERIOR*

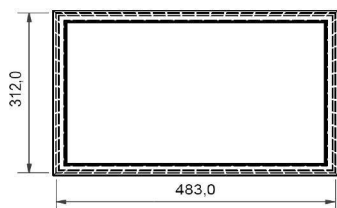

**PT.1320 - BORRACHA PARA PORTA**  
*PT.1320 - DOOR GASKET*

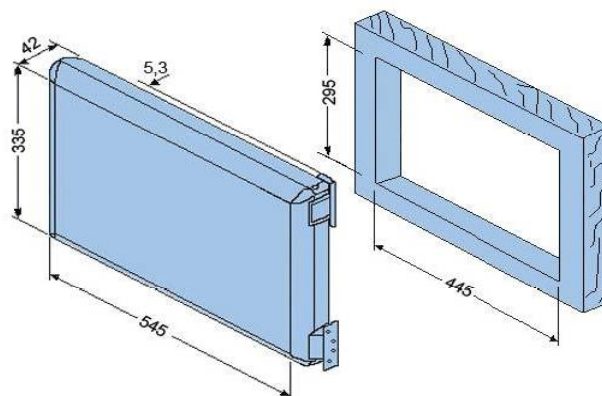

**FECHO AC.1058 PA**  
*LATCH AC.1058 PA*



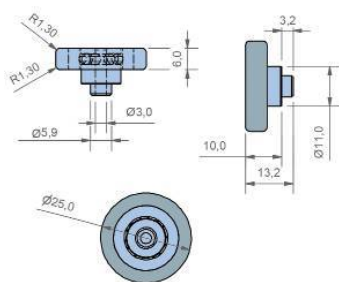

### AC.1007

Rolamento em aço zincado/poliamida (PA) para portas deslizantes

*Zinc plated steel/polyamide (PA) ball bearing for sliding doors*

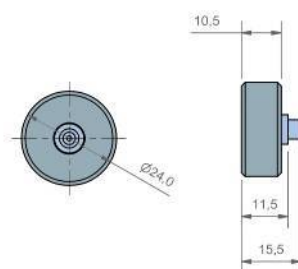

### AC.1008

Rodizio em poliamida(PA) com cravo inox para corredeiras

*Polyamide(PA) bearing with stainless steel stud for drawer slides*

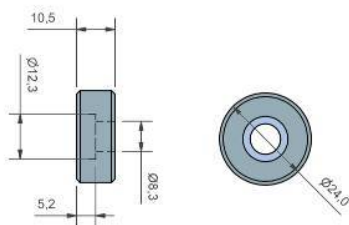

### AC.1040

Rodizio em poliamida(PA) para AC.1008 (parte exterior)

*Polyamide(PA) bearing without stud for AC.1008*

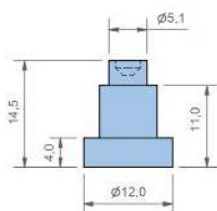

### AC.1040-1

Roleto em inox para rodizio AC.1008

*Stainless steel stud for AC.1008 bearing*

### AC.2583

Rolamento em aço zincado/poliamida (PA) com cravo para portas deslizantes

*Zinc plated steel/polyamide (PA) ball bearing with stud for sliding doors*

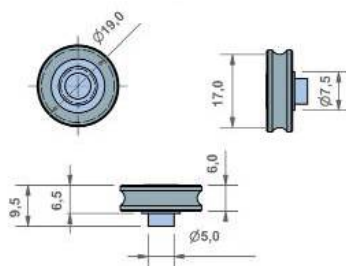

### AC.2582-1

Rolamento em aço zincado/poliamida (PA) para portas deslizantes com rosca M4

*Zinc plated steel/polyamide (PA) ball bearing for sliding doors with M4 thread*

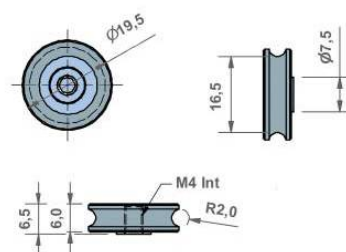

### AC.2580

Rolamento em aço zincado/poliamida (PA) para portas deslizantes com rosca M5

*Zinc plated steel/polyamide (PA) ball bearing for sliding doors with M5 thread*

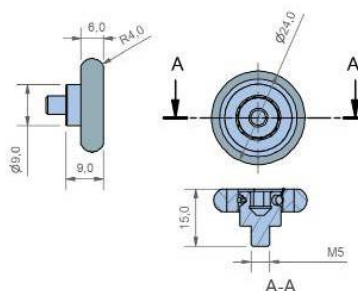

### AC.2585

Rolamento em aço zincado com cravo para portas deslizantes

*Zinc plated ball bearing with stud for sliding doors*

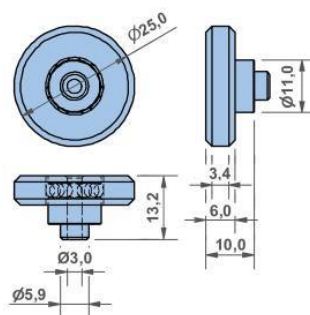

### AC.1182

Rolamento Ø30 em poliamida (PA)/aço zincado  
Inclui parafuso M5

*Ø30 polyamide (PA)/zinc plated steel bearing  
Includes M5 screw*

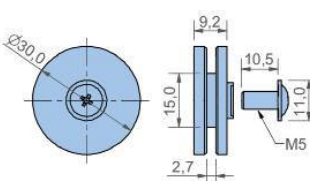

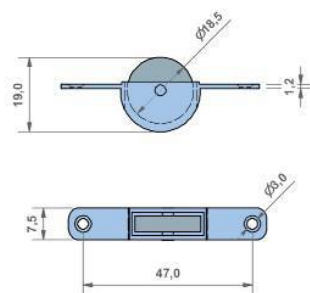

### AC.1001

Suporte em aço zincado com rolete em poliamida (PA) para portas deslizantes

*Zinc plated steel support with polyamide (PA) bearing for sliding doors*

### AC.1001 I

Suporte em aço zincado com rolete em inox para portas deslizantes

*Zinc plated steel support with stainless steel bearing for sliding doors*

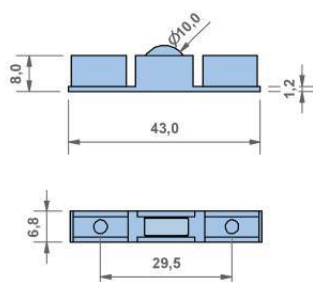

### AC.1027

Roleta aço zincado com parafusos para calha de alumínio

*Zinc plated steel bearing with screws for aluminium track*

### AC.1027 I

Roleta em aço zincado com rolamento em inox para calha de alumínio

*Zinc plated steel support with stainless steel ball bearing for aluminium track*

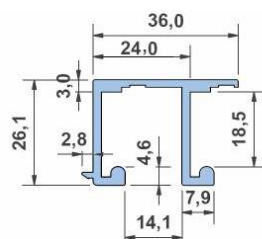

### AC.1395 - 1397

Calha perfil alumínio 36mm para portas deslizantes

*36mm sliding door track in extruded aluminium*

- AC.1395 - 6 Mts
- AC.1396 - 2 Mts
- AC.1397 - 3 Mts

## AC.1415

Suporte em aço zincado para portas deslizantes, com rolamento (AC.2583)

*Zinc plated steel support with (AC.2583) ball bearing for sliding doors*

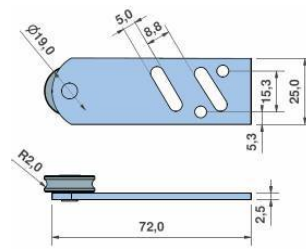

## AC.1400 - 1403

Calha perfil alumínio 46mm para portas deslizantes

*46mm sliding door track in extruded aluminium*

- AC.1400** - 6 Mts
- AC.1402** - 2 Mts
- AC.1403** - 3 Mts

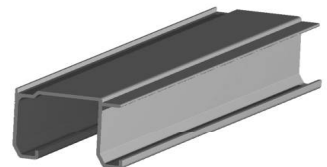
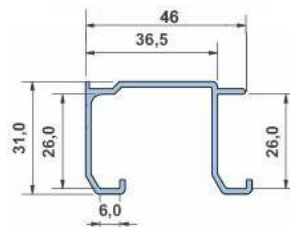

## AC.1004

Suporte em aço zincado para portas deslizantes, com rolamento (AC.1007)

*Zinc plated steel support with (AC.1007) ball bearing for sliding doors*

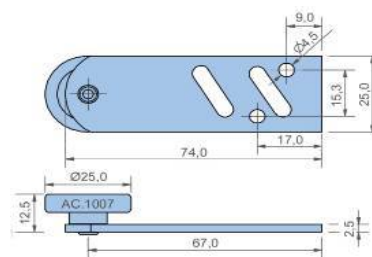

## AC.1408

Suporte anterior em aço zincado para portas deslizantes, com rolamento (AC.1007)

*Front zinc plated steel support with (AC.1007) ball bearing for sliding doors*

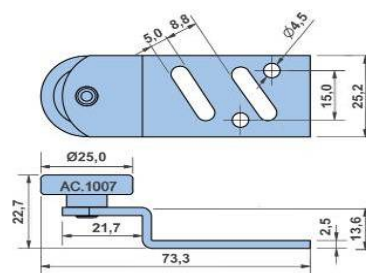

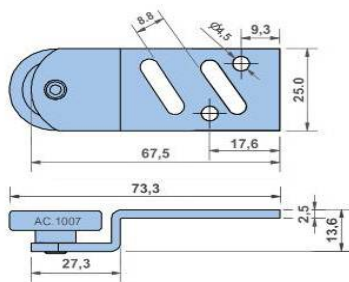

### AC.1408-1

Suporte anterior em aço zincado para portas deslizantes, com rolamento (AC.1007)

*Front zinc plated steel support with (AC.1007) ball bearing for sliding doors*

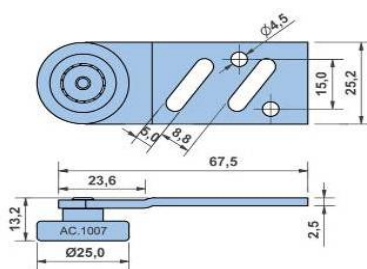

### AC.1410

Suporte posterior em aço zincado para portas deslizantes, com rolamento (AC.1007)

*Rear zinc plated steel support with (AC.1007) ball bearing for sliding doors*

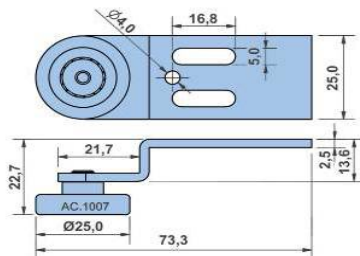

### AC.1438

Suporte anterior em aço zincado para portas deslizantes com rasgo vertical e rolamento (AC.1007)

*Front zinc plated steel support with (AC.1007) ball bearing for sliding doors with vertical groove*

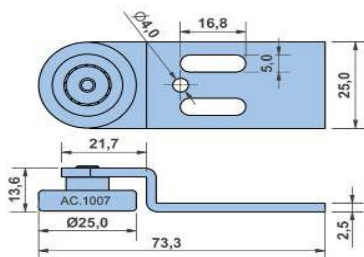

### AC.1438-1

Suporte anterior em aço zincado para portas deslizantes com rasgo vertical e rolamento (AC.1007)

*Front zinc plated steel support with (AC.1007) ball bearing for sliding doors with vertical groove*

## AC.1440

Suporte posterior em aço zincado para portas deslizantes com rasgo vertical e rolamento (AC.1007)

Rear zinc plated steel support with (AC.1007) ball bearing for sliding doors with vertical groove

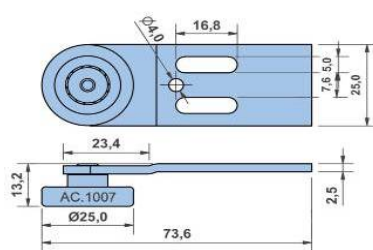

AC.1400 A AC.1403

AC.1395 A AC.1397



AC.1580



AC.1408 / AC.1438

AC.1410 / AC.1440

AC.1415

EXEMPLO DE APLICAÇÃO  
EXAMPLE OF APPLICATION

## AC.1445

Suporte anterior em aço zincado para portas deslizantes, com rolamento em aço zincado (AC.2585)

Front zinc plated steel support with (AC.2585) zinc plated steel ball bearing for sliding doors

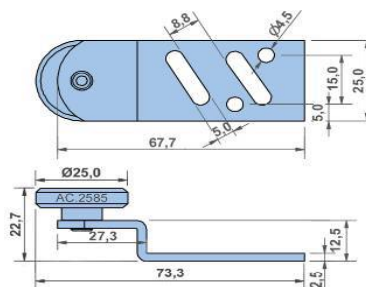

## AC.1445-1

Suporte anterior em aço zincado para portas deslizantes, com rolamento em aço zincado (AC.2585)

Front zinc plated steel support with (AC.2585) zinc plated steel ball bearing for sliding doors

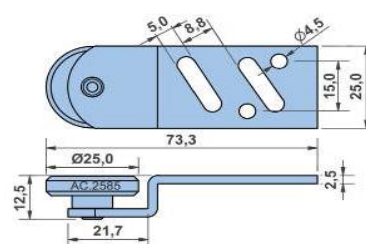

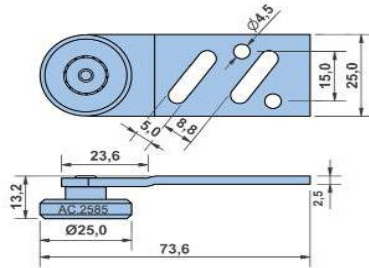

### AC.1446

Suporte posterior em aço zincado para portas deslizantes, com rolamento em aço zincado (AC.2585)

Rear zinc plated steel support with (AC.2585) zinc plated steel ball bearing for sliding doors

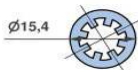
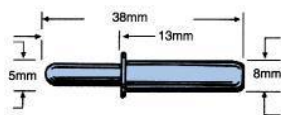

### AC.1405

Pino guia com mola para portas deslizantes

Spring loaded guide pin for sliding doors

✓ Fornecido com anilha de fixação  
Supplied with fixing washer

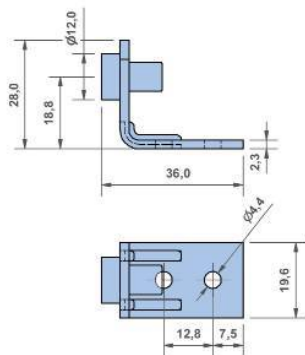

### AC.1406

Batente de borracha para porta deslizante com suporte em aço zincado

Zinc plated steel door stop with rubber bumper

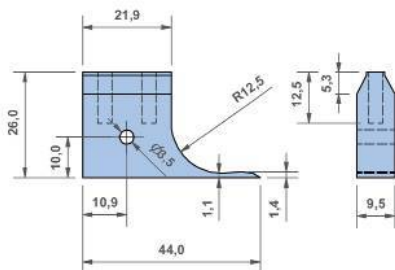
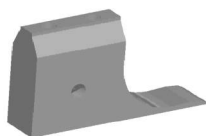

### AC.1580

Bloqueio em poliamida(PA) branca para perfil AC.1400-1403

White polyamide(PA) block for tracks AC.1400-1403

## AC.1411

Guia em poliamida (PA) cinza para portas deslizantes com 19mm

Grey polyamide (PA) door guide for 19mm sliding doors

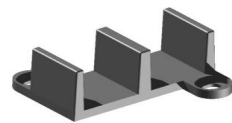
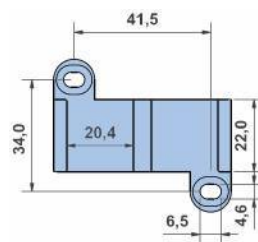

## AC.1412

Guia em ABS/PC cinza para portas deslizantes com 13mm

Grey ABS/PC door guide for 13mm sliding doors

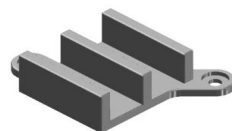
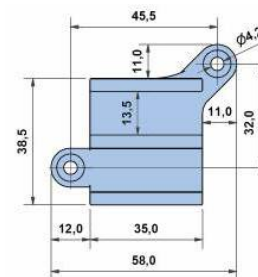

## AC.1029 - 1034

Cremalheira em aço inoxidável AISI 304

Stainless steel AISI 304 pilaster

	A (mm)
AC.1029	1500
AC.1032	1000
AC.1034	2000

✓ Outros comprimentos sob consulta  
Other lengths upon request

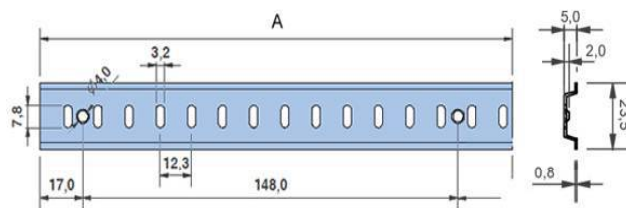

## AC.1036 - 1038

Suportes de cremalheira em aço inoxidável AISI 304

Stainless steel AISI 304 holders for pilaster

	ESPESSURA (mm) THICKNESS (mm)
AC.1036	0.8
AC.1036-1	1.0
AC.1038	0.8
AC.1038-1	1.0

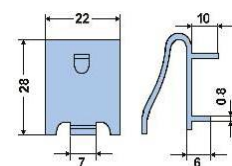
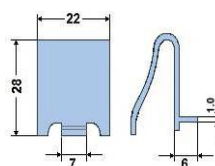

AC.1036 / AC.1036-1

AC.1038 / AC.1038-1

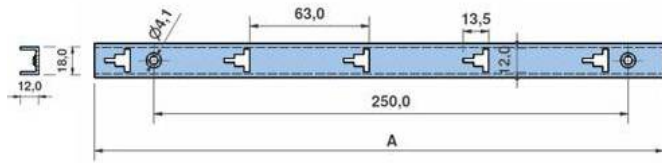

### AC.1770 - 1772

Calha perfurada 18x12mm em alumínio natural

*18x12mm natural aluminum pilaster*

	A (mm)
AC.1770	530
AC.1771	1000
AC.1772	2000

### AC.1775 - 1782

Poleia sem rebordo para calha perfurada 18x12mm em alumínio natural

*Natural aluminum bracket without flange for 18x12mm pilaster*

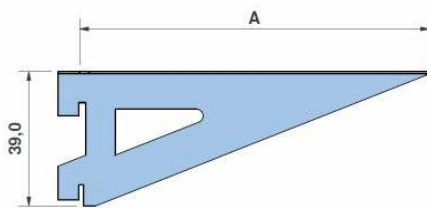
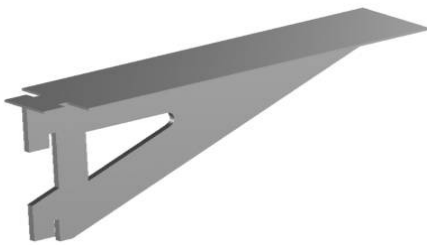

	A (mm)
AC.1775	100
AC.1776	150
AC.1777	200
AC.1778	250
AC.1779	300
AC.1780	350
AC.1781	400
AC.1782	450

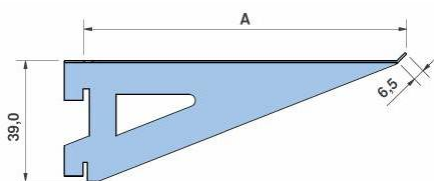
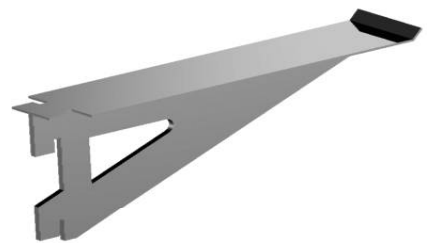

### AC.1783 - 1790

Poleia com rebordo para calha perfurada 18x12mm em alumínio natural

*Natural aluminum bracket with flange for 18x12mm pilaster*

	A (mm)
AC.1783	100
AC.1784	150
AC.1785	200
AC.1786	250
AC.1787	300
AC.1788	350
AC.1789	400
AC.1790	450

## AC.1650

Suporte dobrável e removível em zamak cromado com base em inox com 156x178mm

**Capacidade de carga:** 90kg em 2 suportes

*Folding Removable Shelf Bracket in chrome plated zamak with stainless steel mount, 156x178mm*

**Load capacity:** 90kg per 2 brackets

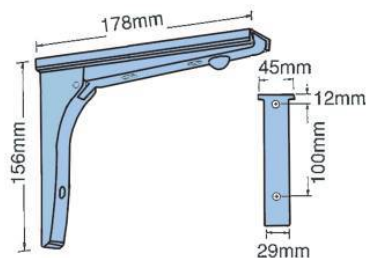

## AC.1651

Suporte dobrável em inox AISI 304 com 89x190mm

**Capacidade de carga:** 68kg em 2 suportes

*AISI 304 stainless steel folding bracket with 89x190mm*

**Load capacity:** 68kg per 2 brackets

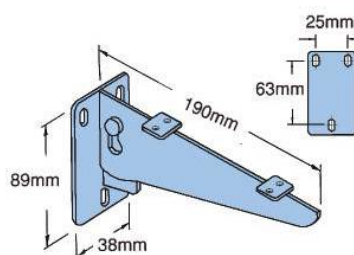

## AC.1652

Suporte dobrável em inox AISI 304 com 86x220mm

**Capacidade de carga:** 90kg em 2 suportes

*AISI 304 stainless steel folding bracket with 86x220mm*

**Load capacity:** 90kg per 2 brackets

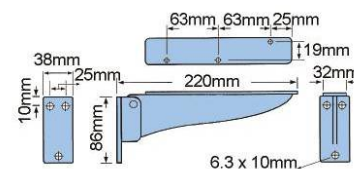

## AC.1653

Suporte dobrável em inox AISI 304 com 86x309mm (para 3 tubos Ø25mm)

**Capacidade de carga:** 68kg em 2 suportes

*AISI 304 stainless steel folding bracket with 86x309mm (for 3 tubes Ø25mm)*

**Load capacity:** 68kg per 2 brackets

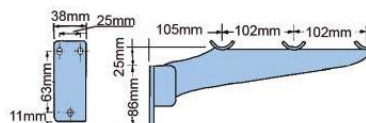

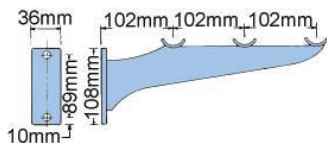

### AC.1654

Suporte fixo em inox AISI 304 com 108x306mm (para 3 tubos Ø25mm)

**Capacidade de carga:** 90kg em 2 suportes

*AISI 304 stainless steel bracket with 108x306mm (for 3 tubes Ø25mm)*

**Load capacity:** 90kg per 2 brackets

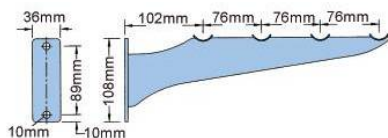

### AC.1655

Suporte fixo em inox AISI 304 com 108x330mm (para 4 tubos Ø25mm)

**Capacidade de carga:** 90kg em 2 suportes

*AISI 304 stainless steel bracket with 108x330mm (for 4 tubes Ø25mm)*

**Load capacity:** 90kg per 2 brackets

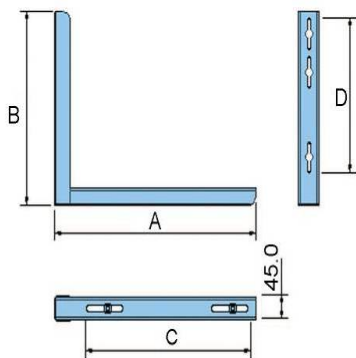

### SP.4235 - SP.5540 R

Suportes para máquinas de ar condicionado

**Opção:** Porcas ajustáveis

*Brackets for air conditioning machines*

**Option:** Running nuts

	A	B	C	D	MATERIAL	CARGA (KG) LOAD (KG)
SP.4235	415	340	335	265	AÇO ZINCADO GALVANIZED STEEL	50
SP.4935	485	340	405	265	AÇO ZINCADO GALVANIZED STEEL	75
SP.5540R	545	390	470	315	AÇO ZINCADO GALVANIZED STEEL	140

## DV.2470 - 2475

Suportes em aço inox para prateleiras  
Espessura Inox - 1.2mm

*Stainless steel supports for shelves*  
*Stainless steel thickness - 1.2mm*

	A	B	C	D	E	F
DV.2470	430	38	16	25	-	-
DV.2471	530	38	16	25	-	-
DV.2472	630	38	20	25	-	-
DV.2473	635	8	20	25	-	-
DV.2474	730	38	20	25	-	-
DV.2475	635	8	-	-	15	28

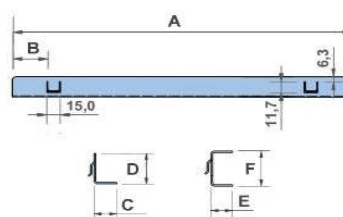

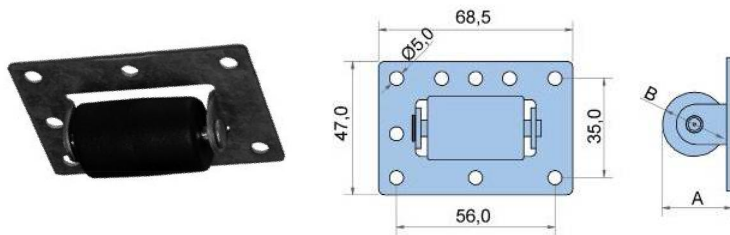

### AC.1005 - 1006

Deslizador em aço zincado/ABS-PC para arcas

*Zinc plated steel and ABS-PC roller for freezers*

	A	ØB
AC.1005	23.0	19
AC.1006	24.5	23

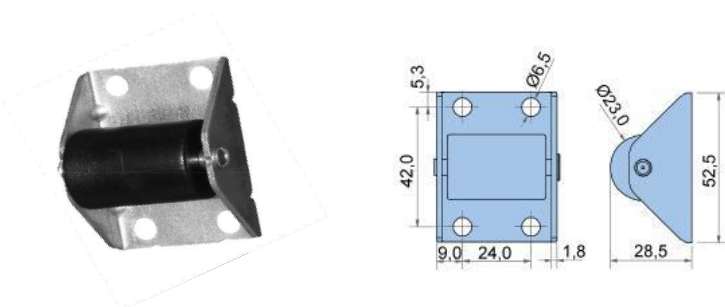

### AC.1350

Deslizador em aço zincado/ABS-PC para arcas

*Zinc plated steel and ABS-PC roller for freezers*

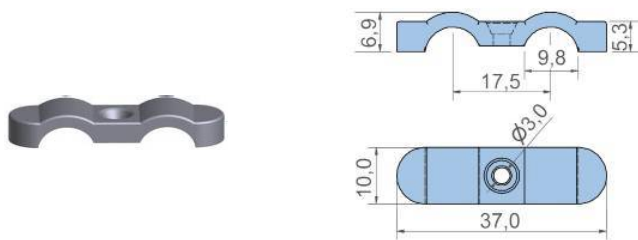

### AC.1059 - AC.1059 B

Abraçadeira dupla em poliamida (PA) para cabo elétrico

*Polyamide(PA) double clamp for electrical cords*

**AC.1059** - Preto / Black  
**AC.1059 B** - Branco / White

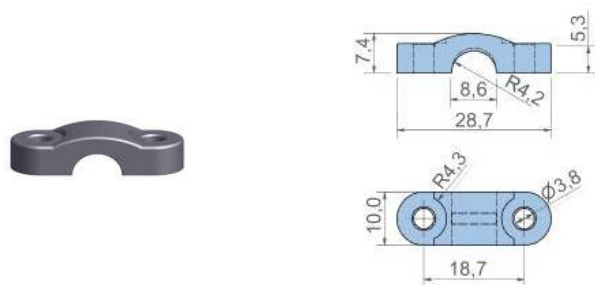

### AC.1060 - AC.1060 B

Abraçadeira simples em poliamida (PA) para cabo elétrico

*Polyamide(PA) single clamp for electrical cords*

**AC.1060** - Preto / Black  
**AC.1060 B** - Branco / White

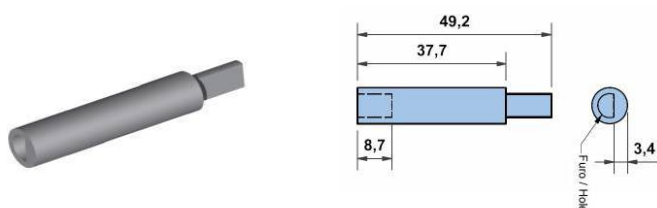

### AC.1175

Suplemento em ABS para termostato

*ABS supplement for thermostat*

### AC.1195-4

Kit bandeja de evaporação em alumínio  
 Resistência com sistema PTC, 220V - 230W  
 Diâmetro da resistência - 12mm  
 Capacidade da bandeja - 1,9L  
 Capacidade de evaporação - 0,200 - 0,250L/h  
 Inclui parafusos de fixação

*Aluminium water evaporation tray kit  
 PTC system resistance, 220V - 230W  
 Resistance diameter - 12mm  
 Capacity - 1,9L  
 Evaporation capacity - 0,200 - 0,250L/h  
 Fixation screws included*

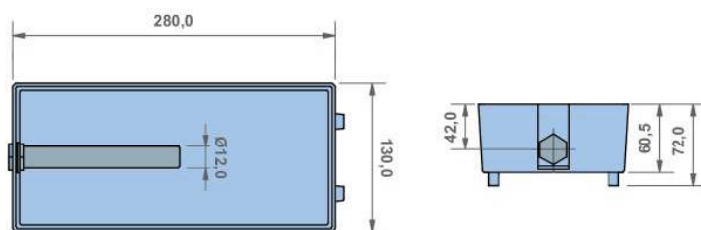

### AC.1199

Bandeja de evaporação em alumínio sem resistência  
*Aluminium water evaporation tray without electrical resistance*

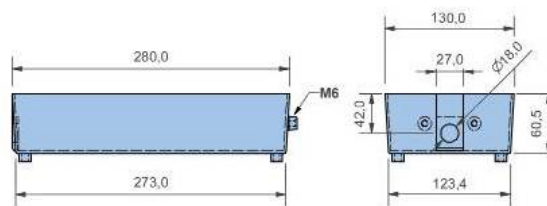

### AC.1197-4

Kit bandeja de evaporação em PP com FV  
 Resistência com sistema PTC, 220V - 230W  
 Diâmetro da resistência - 12mm  
 Capacidade da bandeja - 1,5L  
 Capacidade de evaporação - 0,200 - 0,250L/h

*PP with GF water evaporation tray kit  
 PTC system resistance, 220V - 230W  
 Resistance diameter - 12mm  
 Capacity - 1,5L  
 Evaporation capacity - 0,200 - 0,250L/h*

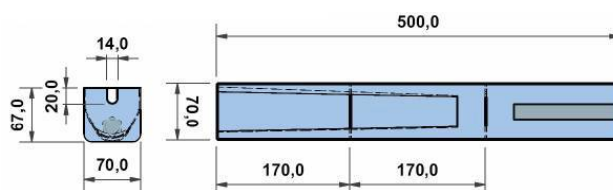

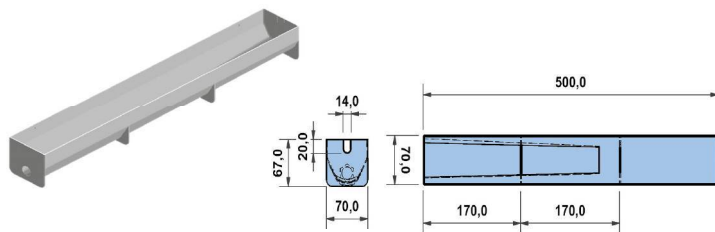

### AC.1198

Bandeja de evaporação em polipropileno (PP) sem resistência

*Polypropylene (PP) water evaporation tray without electrical resistance*

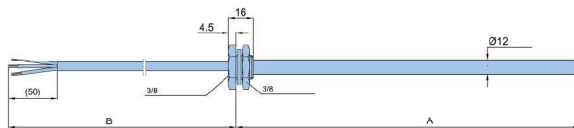

### AC.1203-3 - AC.1203-4

Resistência tipo cartucho de 230V

*Cartridge type resistance - 230V*

	A	B	W
AC.1203-3	240	1100	500
AC.1203-4	175	1500	230



### AC.1205

Bandeja de evaporação em ABS auto-extinguível preto para uso com resistência de 230W  
Capacidade : 3L

*Evaporation tray in self-extinguishing black ABS for use with 230W PTC resistance - Capacity= 3L*

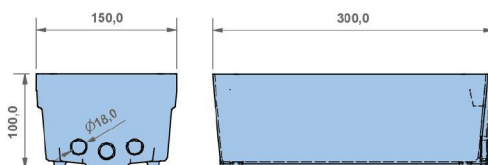

### AC.1206

Bandeja de evaporação em policarbonato(PC) cinza com furo para colocação de resistência PTC  
Capacidade = 3L

*Evaporation tray in grey polycarbonate(PC) with hole for - Capacity= 3L*

## AC.1225

Tampa em poliamida (PA) para furos 90x50mm

*Polyamide (PA) cover for 90x50mm holes*

**AC.1225** - Branco / White

**AC.1225 C** - Cinza / Grey

**AC.1225 P** - Preto / Black

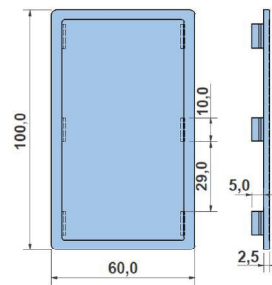

## AC.1338

Válvula 1/2 em LatãoCromado

*1/2 Valve in Chromed Brass*

**AC.1338** - Cromado / Chromed

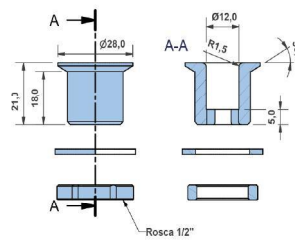

## AC.1346

Válvula de equilíbrio de pressão para armários

*Pressure balancing valve for cabinets*

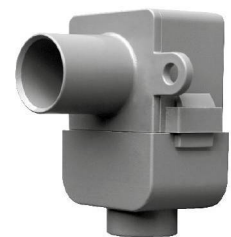
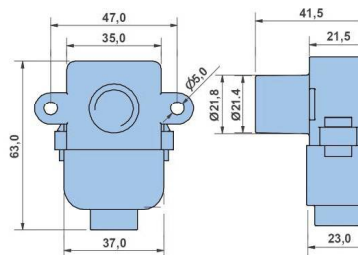

## AC.1800 - AC.1801

Pedal em inox para portas

*Stainless steel foot pedal for doors*

**AC.1800** - Direito / Right

**AC.1801** - Esquerdo / Left

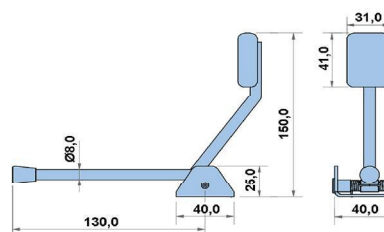



### AC.1253

Kit superior para mesas desmontáveis

**A** - Para prumos em tubo de 40x40mm com espessura de 0,9 a 1,2mm

Nota: Kits fornecidos com parafusos e anilhas

*Superior dismantlable table kit*

*A - For 40x40mm tube with 0,9 to 1,2mm thickness*

*Note: Kits supplied with screws and washers*



### AC.1254

Kit inferior para mesas desmontáveis

**A** - Para prumos em tubo de 40x40mm com espessura de 0,9 a 1,2mm

Nota: Kits fornecidos com parafusos e anilhas

*Inferior dismantlable table kit*

*A - For 40x40mm tube with 0,9 to 1,2mm thickness*

*Note: Kits supplied with screws and washers*



AC.1253



AC.1254

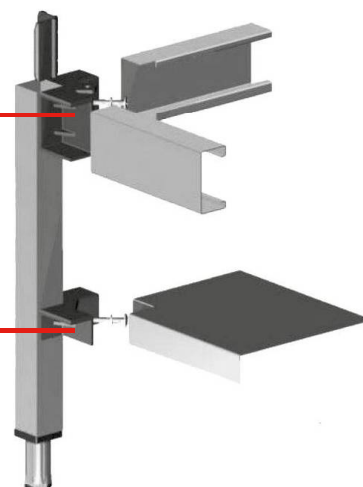

Consulte-nos para tubo 40x40 com furação para kit de mesas  
*Consult us for 40x40 tube with holes for table kit*

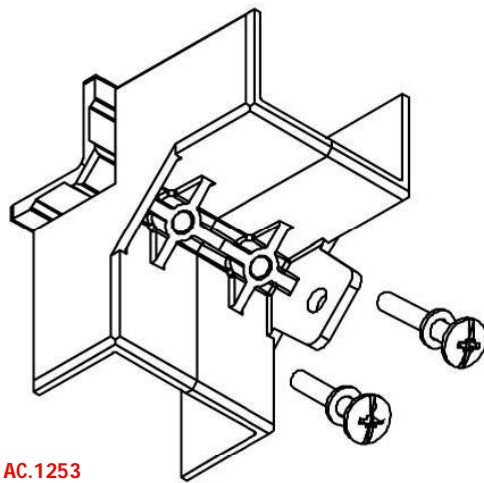

**AC.1253**  
KIT SUPERIOR  
SUPERIOR KIT

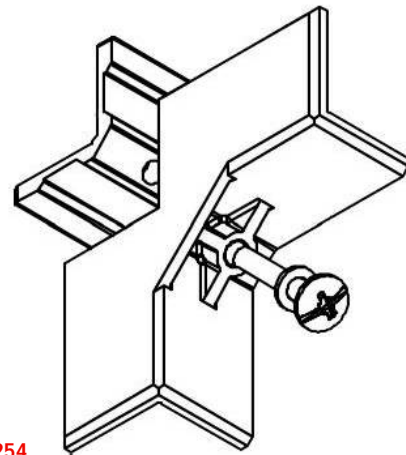

**AC.1254**  
KIT INFERIOR  
INFERIOR KIT

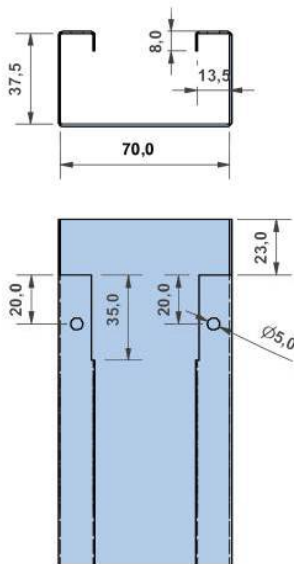
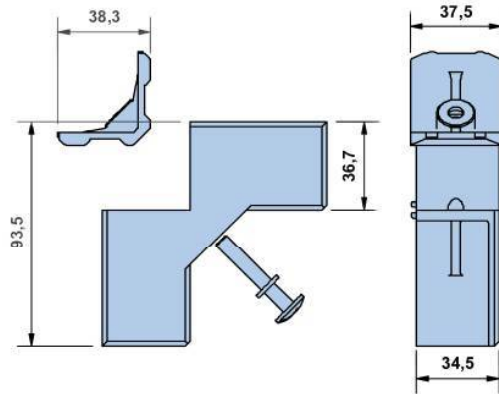
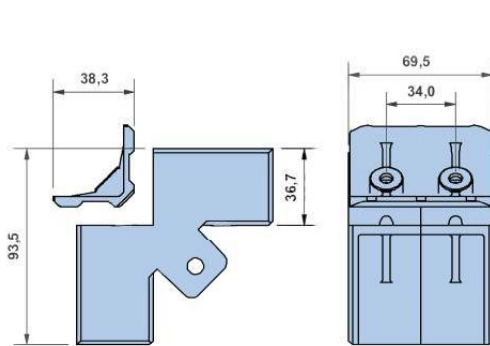

**EXEMPLO DE DIMENSÕES PARA SUPORTES  
LATERAIS DO TAMPO**  
EXAMPLE OF DIMENSIONS LATERAL TABLE SUPPORT

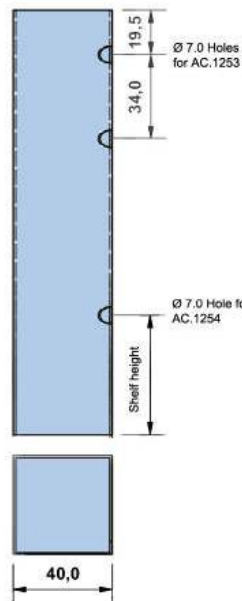
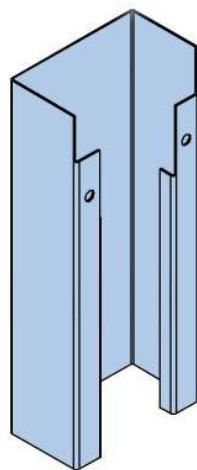

**EXEMPLO DE DIMENSÕES E POSIÇÃO DE FUROS  
PARA APLICAÇÃO DOS KITS**  
EXAMPLE OF DIMENSIONS AND POSITION OF HOLES  
NECESSARY FOR APPLICATION OF THE KITS ON THE  
TABLE LEGS

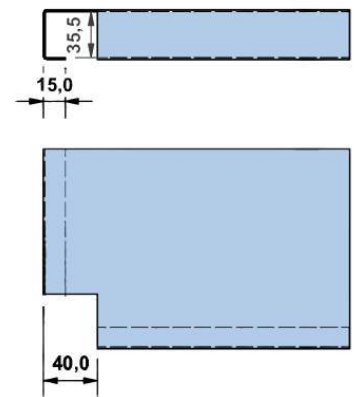

**EXEMPLO DE DIMENSÕES PARA FABRICO DE PRATELEIRA**  
EXAMPLE OF DIMENSIONS FOR SHELF PRODUCTION



**Composição do Kit:**  
 1 - Canto AC.1255-1  
 1 - Parafuso M8x40mm+anilha+porca  
 1 - Interior plástico

*Kit composition:*  
 1 - AC.1255-1 corner  
 1 - M8x40mm screw+washer+nut  
 1 - Plastic interior

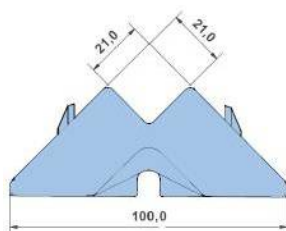

## AC.1255

Kit para mesas desmontáveis simples  
 Para prumos em tubo 40x40mm e travessas  
 40x20mm ou 40x25mm

*Simple dismantlable table kit  
 For 40x40mm leg tube and 40x20mm or 40x25mm crossbar*

## AC.1255-1

Canto em zamak para kits AC.1255 e AC.1256

*Zamak corner for kits AC.1255 and AC.1256*



**Composição do Kit:**  
 2 - Cantos AC.1255-1  
 2 - Parafusos M8x30mm+anilhas+porcas  
 1 - Interior intermédio plástico

*Kit composition:*  
 2 - AC.1255-1 corners  
 2 - M8x30mm screws+washers+nuts  
 1 - Intermediate plastic interior

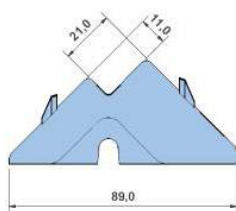

## AC.1256

Kit para mesas desmontáveis triplas  
 Para prumos em tubo 40x40mm e travessas  
 40x20mm e travessa central 40x10mm

*Triple dismantlable table kit  
 For 40x40mm leg tube and 40x20mm or 40x25mm crossbar,  
 and 40x10mm central crossbar*

## AC.1255-10

Canto em zamak para kit AC.1257

*Zamak corner for kit AC.1257*



**Composição do Kit:**  
 2 - Cantos AC.1255-10  
 2 - Parafusos M8x30mm+anilhas+porcas  
 1 - Interior intermédio plástico

*Kit composition:*  
 2 - AC.1255-10 corners  
 2 - M8x30mm screws+washers+nuts  
 1 - Intermediate plastic interior

## AC.1257

Kit em zamak para mesas desmontáveis triplas  
 Para prumos em tubo 40x40mm, travessas 40x20mm ou  
 40x25mm e travessa central 40x20mm

*Triple dismantlable table kit  
 For 40x40mm leg tube and 40x20mm or 40x25mm crossbar,  
 and 40x20mm central crossbar*

**AC.1255**

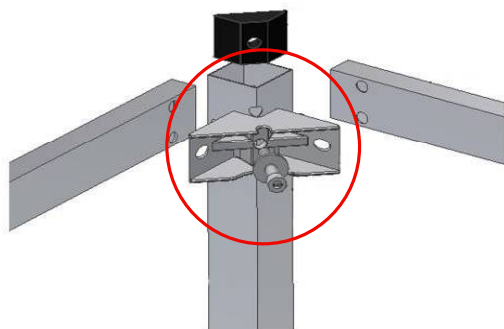

**EXEMPLO DE APLICAÇÃO**  
EXAMPLE OF APPLICATION

**AC.1256 - AC.1257**

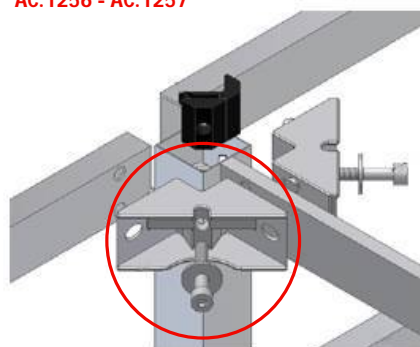

**MESA SIMPLES - 8 KITS AC.1255**  
SIMPLE TABLE - 8 AC.1255 KITS

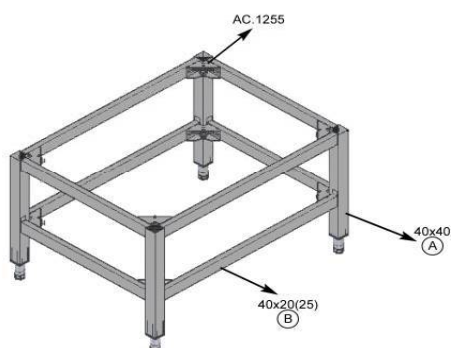

**Furação / Holes**

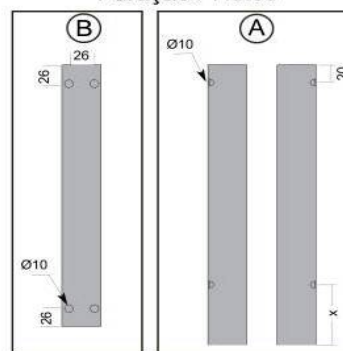

**MESA TRIPLA - 8 KITS AC.1255 + 4 KITS AC.1257**  
TRIPLE TABLE - 8 AC.1255 KITS + 4 AC.1257 KITS

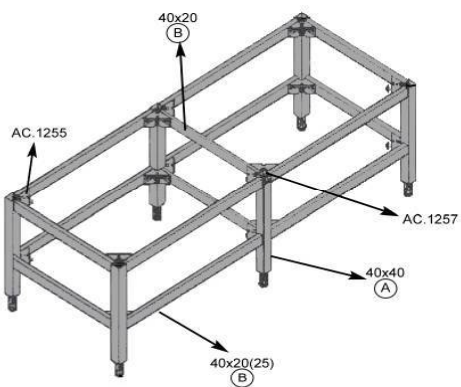

**Furação / Holes**

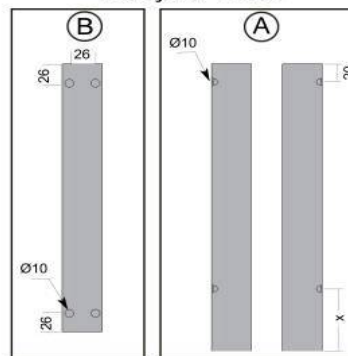

**MESA TRIPLA - 8 KITS AC.1255 + 4 KITS AC.1256**  
TRIPLE TABLE - 8 AC.1255 KITS + 4 AC.1256 KITS

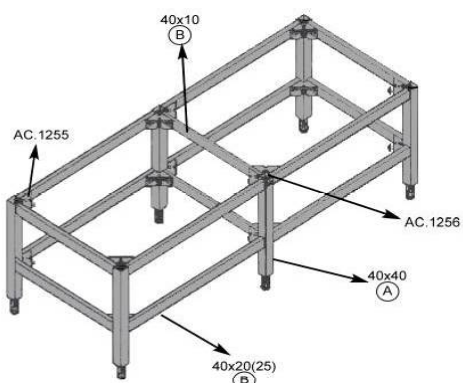

**Furação / Holes**

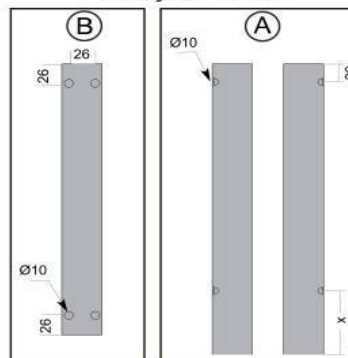

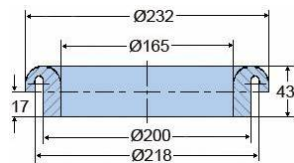

### AC.1063

Gola em borracha de baixa densidade preta para detritos

*Black low density rubber bumper scrap block*

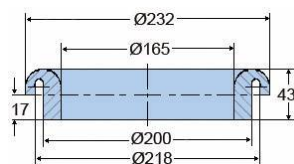

### AC.1064

Gola em borracha de alta densidade para detritos

*High density rubber bumper scrap block*

- AC.1064 - Preto / Black
- AC.1064 A - Azul / Blue
- AC.1064 AM - Amarelo / Yellow
- AC.1064 V - Verde / Green
- AC.1064 VM - Vermelho / Red
- AC.1064 C - Cinza / Grey

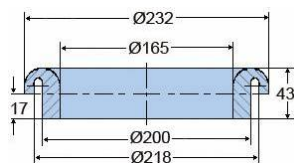

### AC.1065

Gola em silicone preto para detritos

*Black silicone bumper scrap block*

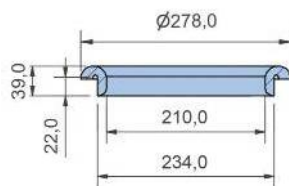

### AC.1066

Gola em borracha de baixa densidade para detritos

*Low density rubber bumper scrap block*

- AC.1066-1 - Preto / Black
- AC.1066-1 A2 - Azul / Blue
- AC.1066-1 AM2 - Amarelo / Yellow
- AC.1066-1 V2 - Verde / Green

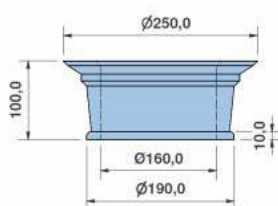

### AC.1068

Gola em borracha de baixa densidade cinza para detritos

*Grey low density rubber bumper scrap block*

- AC.1068 - Cinza / Grey
- AC.1068 P - Preto / Black
- AC.1068 A2 - Azul / Blue
- AC.1068 AM2 - Amarelo / Yellow
- AC.1068 V2 - Verde / Green



### AC.1069

Tampa em inox para gola de detritos AC.1063 a AC.1065

*Stainless steel scrap block lid for AC.1063 to Ac.1065*

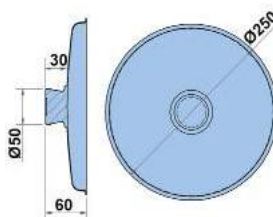

### AC.1069-1

Tampa em aço inox para gola de detritos AC.1066

*Stainless steel scrap block lid for AC.1066*

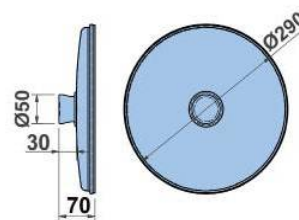

### AC.1069-2

Tampa em aço inox para gola de detritos AC.1068

*Stainless steel scrap block lid for AC.1068*

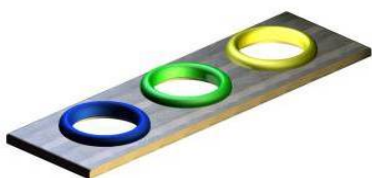
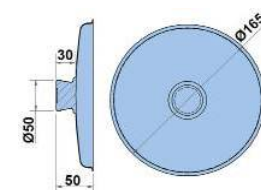

EXEMPLO DE APLICAÇÃO  
EXAMPLE OF APPLICATION



### AC.1079 - AC.1079-1

Aro em aço inox de 1mm para soldar, para AC.1068

*1mm thickness stainless steel ring for welding, suitable for AC.1068*

**AC.1079** - Aro Ø247mm / Rim Ø247

**AC.1079-1** - Aro 285x285mm / Rim 285x285mm

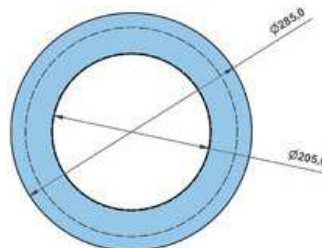
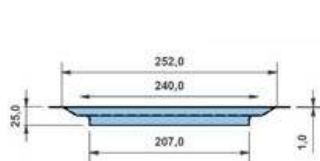

AC.1079

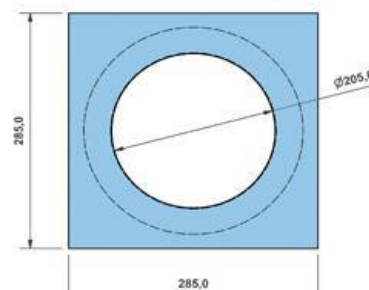
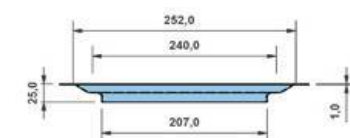

AC.1079-1

### AC.1087

Batente em PVC cinza para tubo redondo

*Grey PVC bumper for round tube*

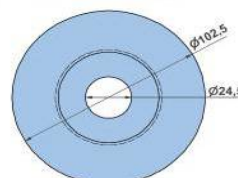
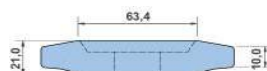

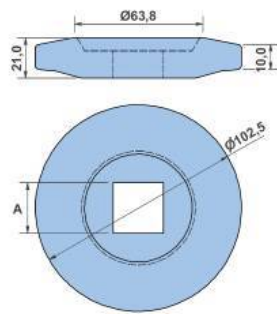

### AC.1088 - AC.1088-2

Batente em PVC cinza para tubo quadrado

Grey PVC bumper for square tube

	A
AC.1088	25x25
AC.1088-1	30x30
AC.1088-2	20x20

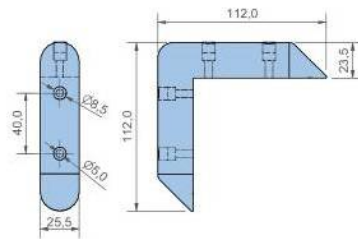

### AC.1091

Canto protetor em PVC cinza

Grey PVC bumper corner

204

⊕ Outras cores sob consulta  
Other colours upon request

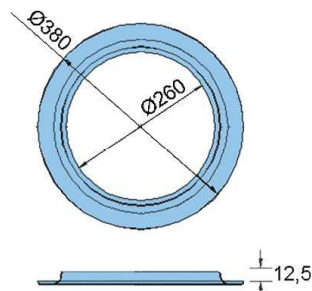

### AC.1041

Olho de boi (par) em inox para porta de 40mm

AISI-304 stainless steel window ring (pair) for 40mm thick doors

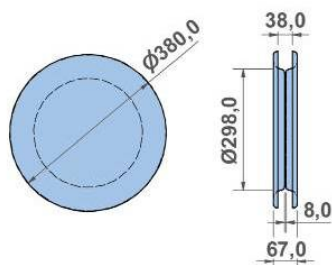

### AC.2041

Conjunto Olho de Boi em aço inox AISI-304, fornecido com parafusos e visor em metacrilato com 8mm de espessura para portas de 40mm

AISI-304 stainless steel window ring(pair), supplied with screws and 8mm thick methacrylate window for 40 mm thick doors

## AC.1050

Gancho em aço inox AISI 304 Ø8 para talho

*Ø8 stainless AISI 304 steel butcher's hook*

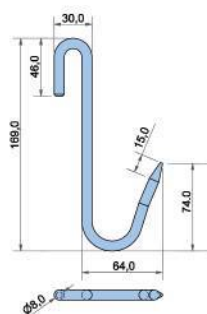

## AC.1815

Ganchos "S" em aço inox AISI 430 para talho

*"S" butcher's hooks in stainless steel AISI 430*

	A	Ø	B	C
AC.1815-1	60	3	20	30
AC.1815-2	80	4	28	32
AC.1815-3	100	4	30	38
AC.1815-4	120	4	34	45
AC.1815-5	140	5	36	50
AC.1815-6	160	6	40	55
AC.1815-7	180	8	50	70
AC.1815-8	200	10	55	70
AC.1815-9	220	10	60	75

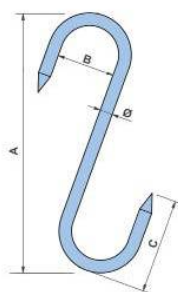

## AC.1810

Tabuleiro porta talheres em polipropileno (PP) cinza com 530x325x100mm

*Grey polypropylene (PP) cutlery tray with 530x325x100mm*



## AC.1811

Tampa em polipropileno (PP) semitransparente para tabuleiro porta talheres AC.1810

*Semi-transparent polypropylene (PP) lid for cutlery tray AC.1811*



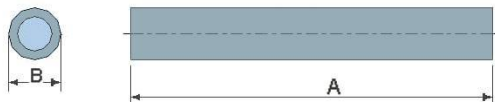

### AC.1420 - 1424

Batente em borracha baixa densidade preta para tulha de café

*Black low density rubber bumper for waste hopper*

	A	ØB	
AC.1420	450	36	
AC.1421	1000	36	
AC.1422 *	328	36	
AC.1423 *	160	36	
AC.1424	350	36	

 \* Roscado nos topos  
\* Threaded on ends

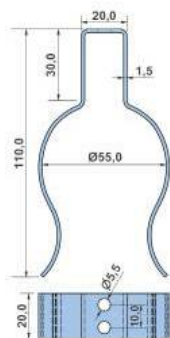
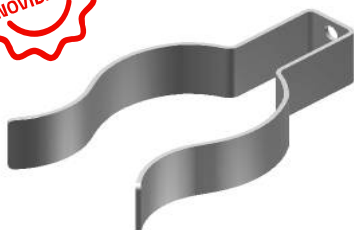

### AC.1830

Mola de chapa 20x110 para fixação de rodapé em pés/tubo redondo de Ø50-65mm

*Kick plate 20x110 spring clamp for round Ø50-65mm feet/tube*



EXEMPLO DE APLICAÇÃO  
EXAMPLE OF APPLICATION

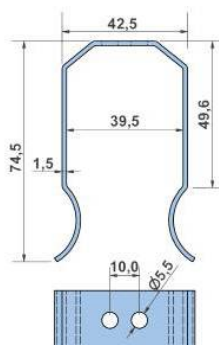

### AC.1831

Mola de chapa 20x64 para fixação de rodapé em pé/tubo quadrado de 40mm

*Kick plate 20x64 spring clamp for 40mm square feet/tube*

## AC.1832

Mola de chapa 25x60 para fixação de rodapé em pé/tubo Ø30-50mm

*Kick plate 25x60 spring clamp for Ø30-50mm feet/tube*

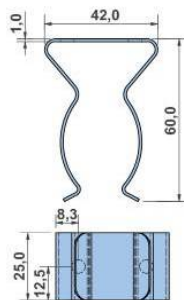

## FL.100-600

Filtro de lamelas para chaminés de extração

*Extractor hood blade filter*

	<b>MATERIAL</b> <i>MATERIAL</i>	<b>DIMENSÕES</b> <i>DIMENSIONS</i>
FL.100	<b>INOX AISI 304 BRILHANTE</b> <i>BRIGHT AISI 304 STAINLESS STEEL</i>	490X490X48
FL.110	<b>INOX AISI 430</b> <i>AISI 430 STAINLESS STEEL</i>	490X490X48
FL.200	<b>AÇO GALVANIZADO</b> <i>GALVANIZED STEEL</i>	490X490X48
FL.230	<b>INOX AISI 430</b> <i>AISI 430 STAINLESS STEEL</i>	500X500X50
FL.600	<b>INOX AISI 430 BRILHANTE</b> <i>BRIGHT AISI 430 STAINLESS STEEL</i>	490X490X25



## FL.220

Filtro de rede para chaminés de extração

*Extractor hood mesh filter*

	<b>MATERIAL</b> <i>MATERIAL</i>	<b>DIMENSÕES</b> <i>DIMENSIONS</i>
FL.220	<b>AÇO GALVANIZADO</b> <i>GALVANIZED STEEL</i>	490X490X48





## CV.0011

---

Balde do lixo em inox AISI 304  
Capacidade 50 Lt  
Tampa removível  
2 rodas Ø63  
1 pega para transporte

*Stainless steel AISI 304 trash bin  
50 Lt capacity  
Removable lid  
2 wheels Ø63  
1 handle for towing*

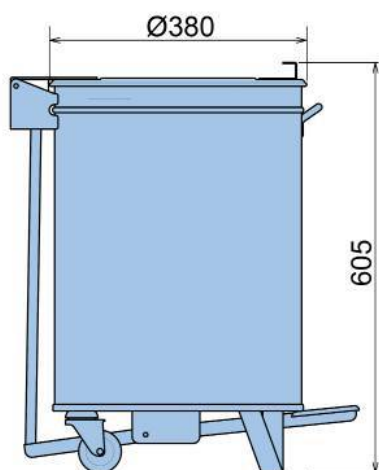



## AC.1110 - 1111

Tubo de esgoto em poliamida (PA)

*Polyamide (PA) drain tube*

	A	B	C	D	E	F	ROSCA THREAD	COR COLOUR
AC.1110	8	2	16.6	69	24	3	3/8"	BRANCO WHITE
AC.1110 C	8	2	16.6	69	24	3	3/8"	CINZA GREY
AC.1110 P	8	2	16.6	69	24	3	3/8"	PRETO BLACK
AC.1111	9	2	26.6	90	40	4.5	3/4"	BRANCO WHITE
AC.1111 C	9	2	26.6	90	40	4.5	3/4"	CINZA GREY
AC.1111 P	9	2	26.6	90	40	4.5	3/4"	PRETO BLACK

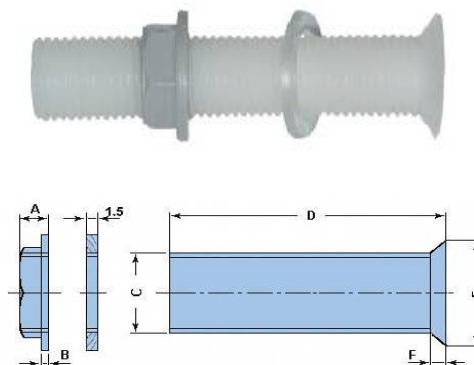

## AC.1123 - 1124

Tubo de esgoto em poliamida (PA) cinza

*Grey polyamide (PA) drain tube*

	A	B	C	D	E	ROSCA THREAD
AC.1123	15.5	5	32	80	30	1"
AC.1124	15.5	5	42	80	39	1 1/4"

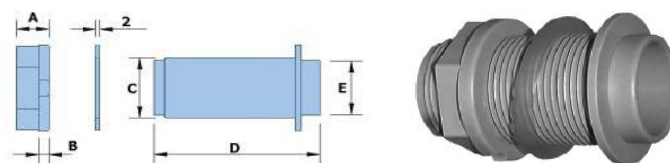

## AC.1124-1

Tubo de esgoto em poliamida (PA) cinza  
Rosca 1 1/4"

*Grey polyamide (PA) drain tube  
Thread 1 1/4"*

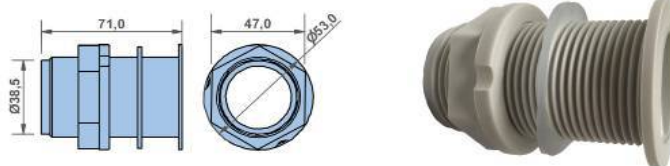

## AC.1100

Tampa em poliamida (PA6) c/ o ring para tubo esgoto  
AC.1111

*Polyamide (PA6) cap with o ring for AC.1111 drain tube*

AC.1100 - Branco / White  
AC.1100 C - Cinza / Grey

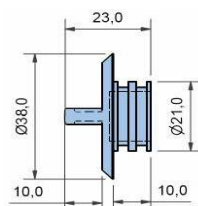

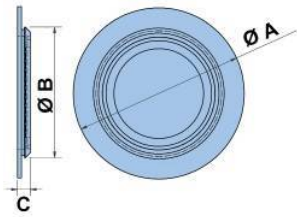

### AC.1500 - 1501

Passa cabos em polipropileno (PP) preto

*Black polipropylene (PP) cable protector*

	A	B	C
AC.1500	68	50	5
AC.1501	68	60	5

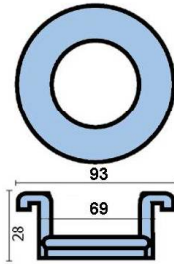

### PR.40

Passa cabos em inox AISI 304

*AISI 304 stainless steel cable protector*



### AC.1170-45

Fechadura em ABS/PC branco para armário vertical  
Para porta de 45mm

White ABS/PC lock for vertical cabinets  
For 45mm doors

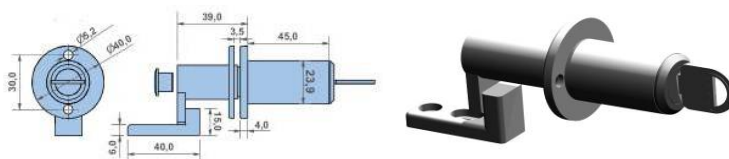

### AC.1170-50

Fechadura em ABS/PC branco para armário vertical  
Para porta de 50mm

White ABS/PC lock for vertical cabinets  
For 50mm doors

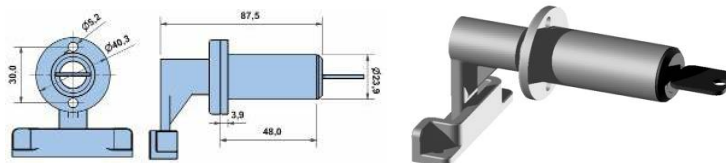

### AC.1172

Bloco em ABS branco com fechadura

White ABS block with lock

### AC.1172-1

Bloco em ABS branco com fechadura e sistema  
de segurança;

White ABS block with lock and security system;

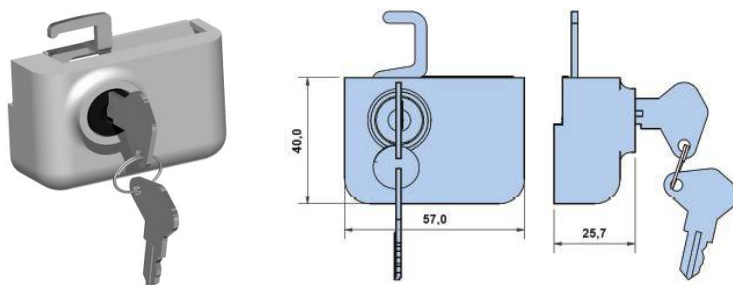

### AC.1360-1363

Fecho de pressão em inox

Stainless steel pressure latch hinge

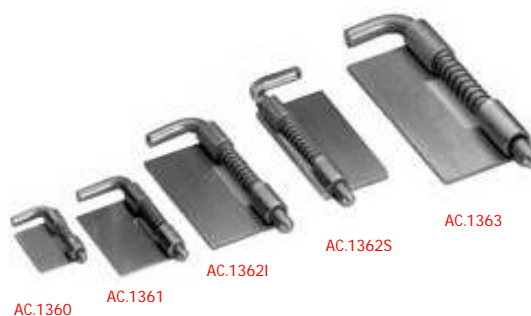

	A	C	D	E	ESPESSURA THICKNESS
AC.1360	22	3.1	12.7	4.7	0.8
AC.1361	35	3.9	19	6.3	1
AC.1362 S	50	5.0	22.2	9.5	1.5
AC.1362 I	50	5.0	22.2	9.5	1.5
AC.1363	70	6.3	25	12.7	1.5

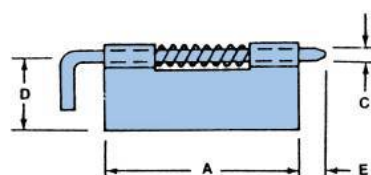

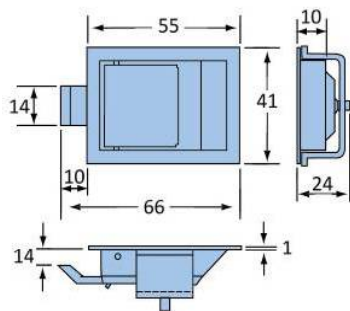

### AC.1370

Fecho pala em aço inox  
Stainless steel paddle latch

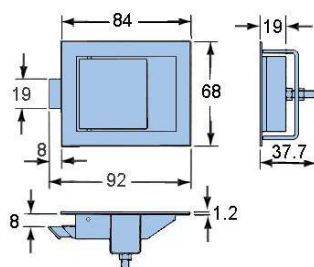

### AC.1371 / AC.1371-1

Fecho pala em aço inox s/ chave  
Fecho pala em aço inox c/ chave  
Stainless steel without key paddle latch  
Stainless steel with key paddle latch

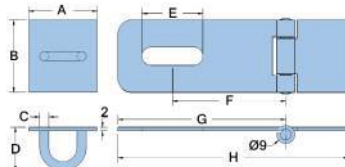
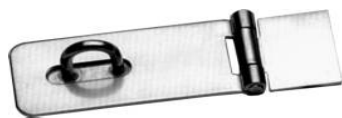

### AC.1450 - AC.1451

Fecho em aço inox  
Stainless steel clasp latch

	A	B	C	D	E	F	G	H
AC.1450	28	25	Ø3	18	25	48	63	94
AC.1451	36	38	Ø5	23	32	60	89	122

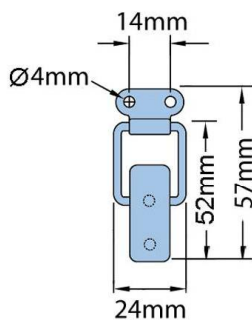

### AC.1460

Fecho de pressão em aço inox  
Stainless steel clasp pressure latch



### AC.1461

Fecho de pressão em aço inox  
*Stainless steel clasp pressure latch*

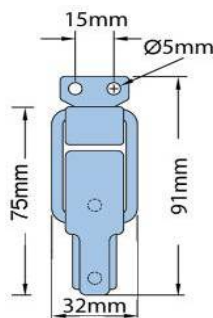

### AC.1071 - 1074

Fecho de embutir  
*Spring loaded door catch*

	MOLA SPRING	ESTRUTURA STRUCTURE
AC.1071	1.8MM AÇO ZINCADO 1.8MM ZINC PLATED STEEL	AÇO ZINCADO ZINC PLATED STEEL
AC.1072	1.8MM AÇO INOX 1.8MM STAINLESS STEEL	ALUMÍNIO ALUMINIUM
AC.1073	2.0MM AÇO ZINCADO 2.0MM ZINC PLATED STEEL	AÇO ZINCADO ZINC PLATED STEEL
AC.1074	2.0MM AÇO INOX 2.0MM STAINLESS STEEL	ALUMÍNIO ALUMINIUM

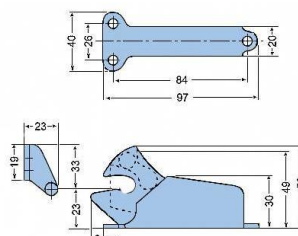

### AC.1545

Fecho em aço zincado com rolete  
*Zinc plated steel catch with roller*

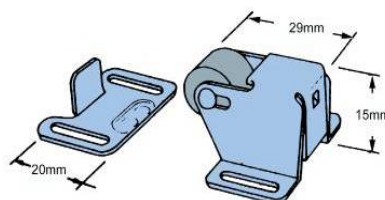

### AC.432/50LN - 432/60LP

Fecho de dupla esfera em latão  
*Brass double ball catch*

	ACABAMENTO FINISH	A	B	C	D	E	F
AC.432/50LN	NIQUELADO NICKEL PLATED	50	9	11	26	9	10
AC.432/50LP	POLIDO POLISHED	50	9	11	26	9	10
AC.432/60LN	NIQUELADO NICKEL PLATED	60	10	12	35	10	11.5
AC.432/60LP	POLIDO POLISHED	60	10	12	35	10	11.5

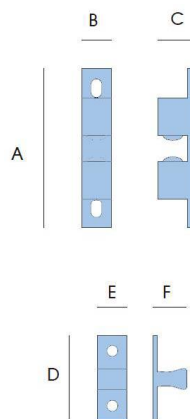

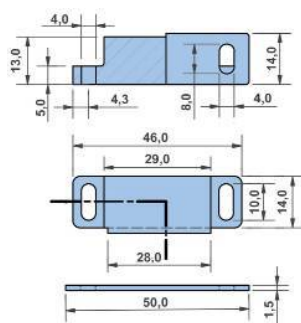

### AC.1014

Fecho magnético em ABS branco

*White ABS magnetic catch*

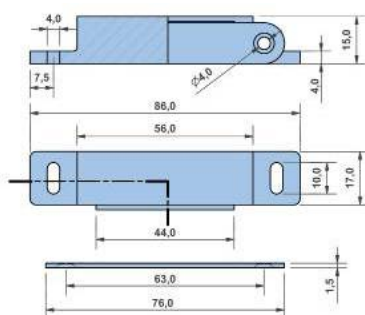

### AC.1016 - AC.1016 B

Fecho magnético em ABS

*ABS magnetic catch*

**AC.1016** - Castanho / *Brown*

**AC.1016 B** - Beije / *Beige*

214

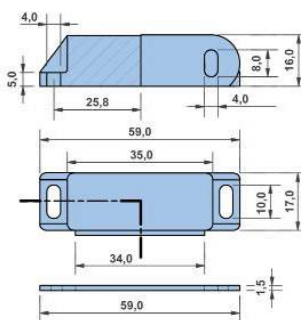

### AC.1017

Fecho magnético em ABS branco

*White ABS magnetic catch*

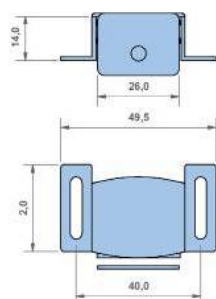

### AC.1542

Fecho magnético metálico de alta resistência

*Metalic high strength magnetic catch*

## AC.1543

Fecho magnético metálico de alta resistência

*Metalic high strength magnetic catch*

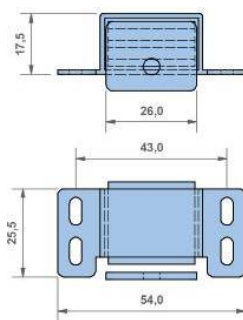

**COMPONENT**  
HARDWARE

## AC.1546

Fecho magnético metálico

*Metalic magnetic catch*

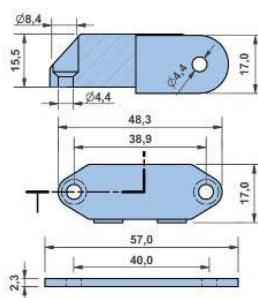

## AC.1490-1492

Fechadura com frente em aço inox Ø22  
Rotação a 180°

*Ø22 stainless steel faced lock  
180° rotation*

	A	B	C
AC.1490	16	40	22
AC.1491	22	40	28
AC.1492	28	40	35

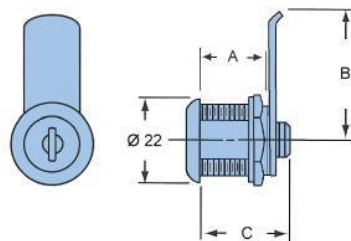

**COMPONENT**  
HARDWARE

## AC.1493 - AC.1494-4

Fechadura com frente em aço inox Ø23,5  
Chaves diferentes

*Ø23,5 stainless steel faced lock  
Keyed different*

	A	B
AC.1494	16	30
✓ AC.1494-1	25	30
AC.1494-2	20	30
AC.1494-3	30	30
AC.1494-4	40	30

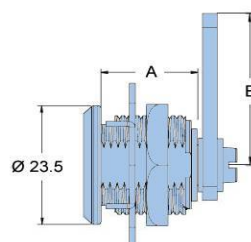

✓ Disponíveis com chaves iguais  
*Available keyed alike*

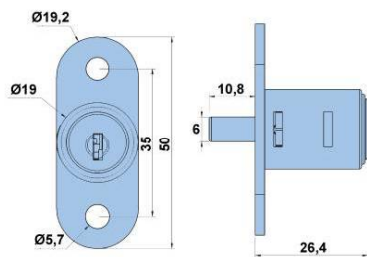

### AC.1364-1

Fecho em "T" niquelado

Nickel plated plunger lock

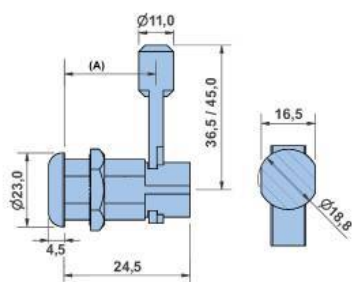

### AC.1368

Fecho em zamak com linguete redondo

Zamak lock with round bolt

AC.1368-2 - Chaves iguais / keyed alike (A) = 21mm

AC.1368-21 - Chaves diferentes / Keyed different (A) = 21mm

AC.1368-3 - Chaves diferentes / Keyed different (A) = 17mm

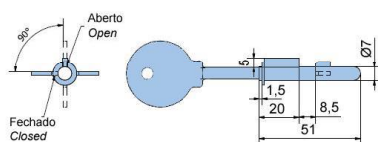

### AC.1631

Fechadura para arca de gelados

Lock for ice cream freezer

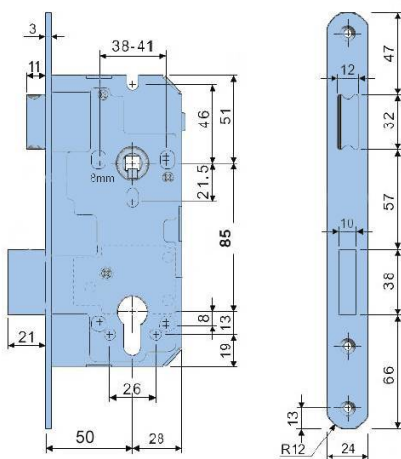

### AC.1372

Fechadura para cilindro europeu com testa arredondada de 240x24mm

Lock for euro-type cylinder with rounded corners with 240x24mm

## AC.1374

Fechadura para cilindro tipo europeu com testa quadrada de 235x24mm

Lock for euro-type cylinder with square corners with 235x24mm

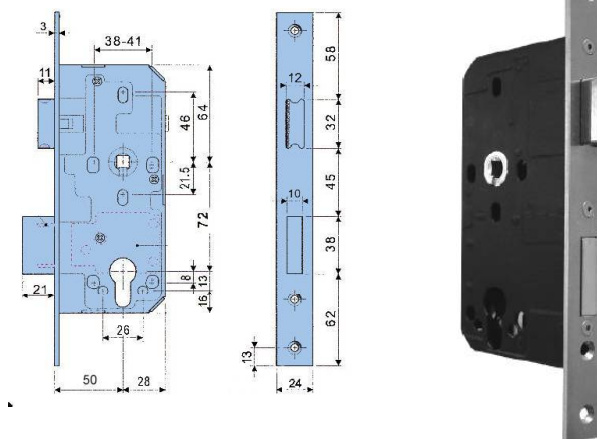

## AC.1375-1384

Cilindro tipo europeu em latão niquelado

Nickel plated brass euro-type cylinder

	A	B
AC.1375	30.5	30.5
AC.1376	30.5	50.5
AC.1378 *	30.5	50.5
AC.1380 *	30.5	30.5
AC.1384 *	25.0	25.0

 \* Com chaves iguais  
\* With keys alike

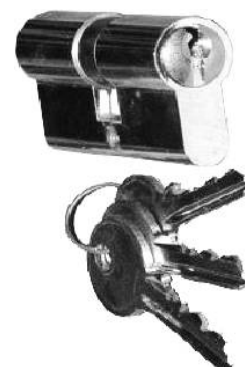
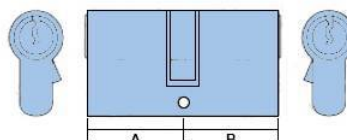

## AC.1795 - AC.1796

Chapa testa em inox AISI 304

AISI 304 stainless steel strike plate

	A
AC.1795	35.0
AC.1796	36.0

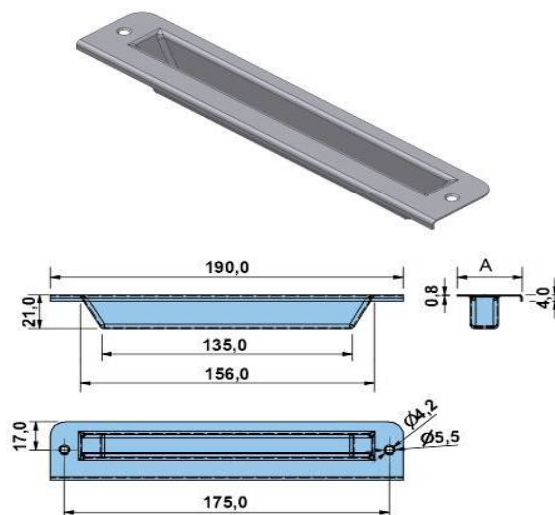

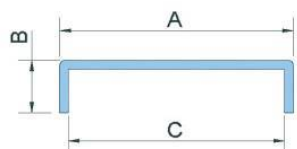
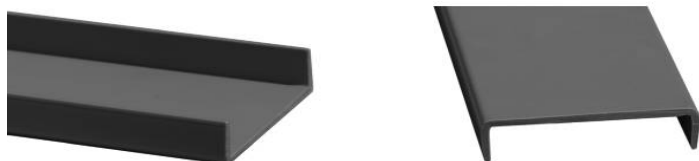

### PF.AR00-AR01

Perfil em PVC cinza

*Grey PVC profile*

	A	B	C
PF.AR00	43.5	10	40
PF.AR01	52.5	12	50

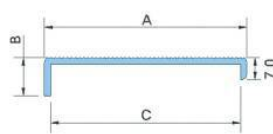
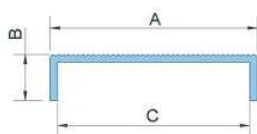
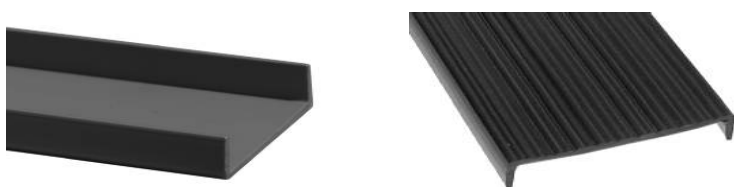

### PF.AR02-AR03

Perfil em PVC preto

*Black PVC profile*

	A	B	C
PF.AR02	64	10	60
PF.AR03	63.3	12	60

218

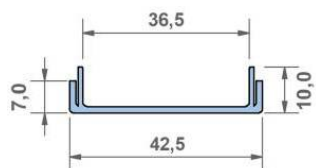
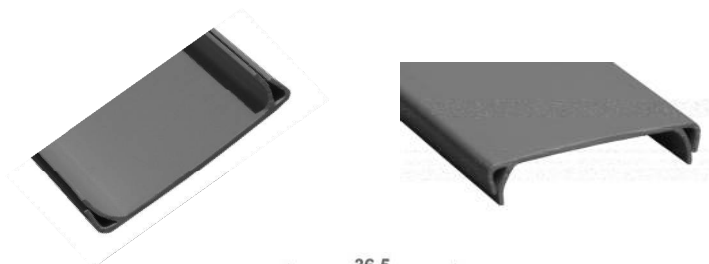

### PF.AR07

Perfil em PVC

*PVC profile*

**PF.AR07** - Preto / Black  
**PF.AR07 C** - Cinza / Grey

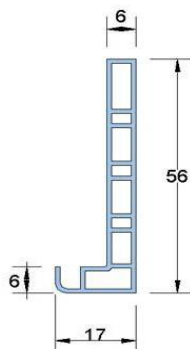

### PF.201

Perfil em PVC para remate de câmara (3mts.)

*PVC profile trim for cold rooms (3mts.)*

**PF.201** - Preto / Black  
**PF.201 C** - Cinza / Grey

Perfis soldados à medida sob consulta  
Welded gaskets upon request

## PF.202

Canto em poliamida (PA) para união de perfil de remate de câmara PF.201

*Polyamide(PA) angle connector for PF.201 profile*

**PF.202** - Preto / Black  
**PF.202 C** - Cinza / Grey

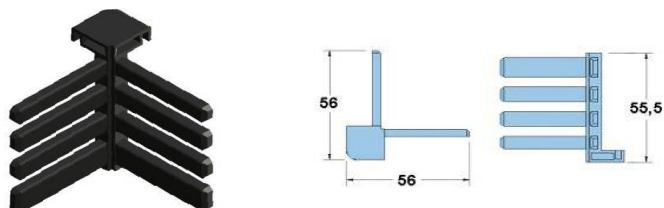

## PT.1250

Perfil em PVC flexível  
**Opção:** Com magnético

*Flexible PVC profile*  
*Option: With magnet*

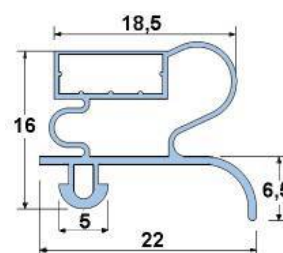

## PT.1260

Perfil em PVC flexível  
**Opção:** Com magnético

*Flexible PVC profile*  
*Option: With magnet*

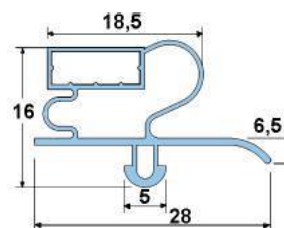

## PT.1350

Perfil em PVC flexível  
**Opção:** Com magnético

*Flexible PVC profile*  
*Option: With magnet*

Encaixa no perfil PT.1361;  
*Fits on PT.1361 profile;*

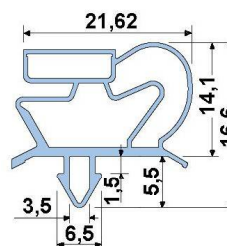

## PT.1361

Perfil em PVC rígido

*Rigid PVC profile*

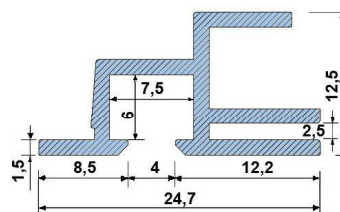



✓ Perfis soldados à medida sob consulta  
*Welded gaskets upon request*

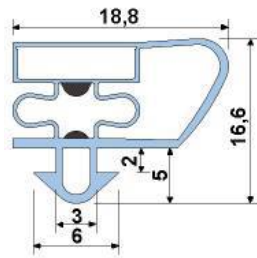

### PT.1351

Perfil em PVC flexível  
**Opção:** Com magnético

*Flexible PVC profile*  
*Option: With magnet*

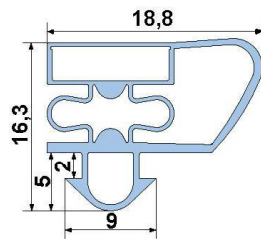

### PT.1352

Perfil em PVC flexível  
**Opção:** Com magnético

*Flexible PVC profile*  
*Option: With magnet*

220

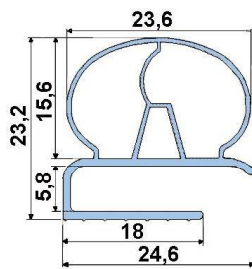

### PT.1355

Perfil em PVC flexível

*Flexible PVC profile*

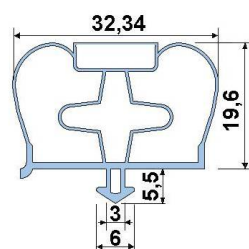

### PT.1357

Perfil em PVC flexível  
**Opção:** Com magnético

*Flexible PVC profile*  
*Option: With magnet*

 Perfis soldados à medida sob consulta  
 Welded gaskets upon request

## PT.1358

Perfil em PVC flexível  
**Opção:** Com magnético

*Flexible PVC profile*  
*Option: With magnet*

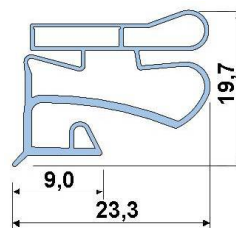

## PT.1362

Perfil em borracha branca

*White rubber profile*

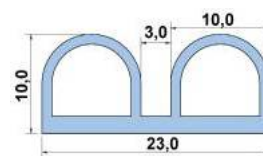

## PT.1363

Perfil em borracha

*Rubber profile*

**PT.1363** - Branco / *White*  
**PT.1363 P** - Preto / *Black*

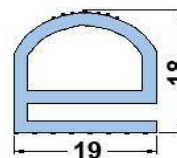

## PT.1364

Perfil em silicone cinza

*Grey silicone profile*

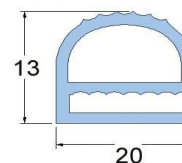

## PT.1365

Perfil em PVC flexível

*Flexible PVC profile*

**PT.1365 N** - Preto / *Black*  
**PT.1365 G** - Cinza / *Grey*

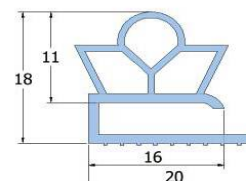



✓ Perfis soldados à medida sob consulta  
*Welded gaskets upon request*

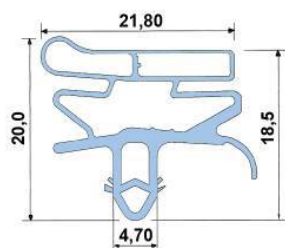

### PT.1610

Perfil em PVC flexível  
**Opção:** Com magnético

*Flexible PVC profile*  
*Option: With magnet*

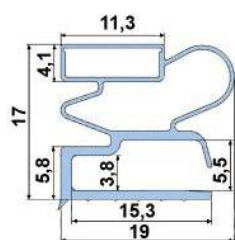

### PT.1649

Perfil em PVC flexível  
**Opção:** Com magnético

*Flexible PVC profile*  
*Option: With magnet*

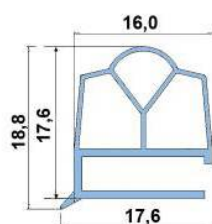

### PT.1657

Perfil em PVC flexível

*Flexible PVC profile*

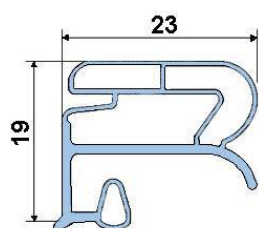

### PT.1728

Perfil em PVC flexível  
**Opção:** Com magnético

*Flexible PVC profile*  
*Option: With magnet*

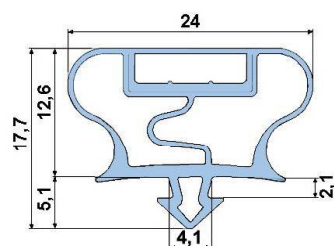

### PT.1763

Perfil em PVC flexível  
**Opção:** Com magnético

*Flexible PVC profile*  
*Option: With magnet*

Perfis soldados a medida sob consulta  
Welded gaskets upon request

## PT.1765

Perfil em PVC flexível

*Flexible PVC profile*

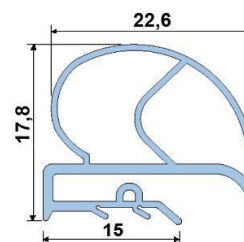

## PT.1372-1373

Perfil magnético

*Magnetic profile*

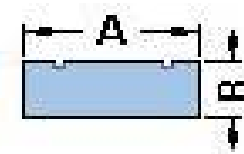

	A	B	POLARIZAÇÃO POLARIZATION
PT.1372	9.1	2.1	SNS
PT.1373	9.0	3.0	SNS



## SUPORTES AJUSTÁVEIS EM INOX AISI-316 POLIDO ADJUSTABLE POLISHED AISI-316 STAINLESS STEEL BRACKETS

✓ Acabamento satinado sob consulta  
Satin finish under request

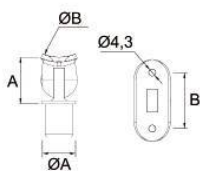

CO.SA400(X)

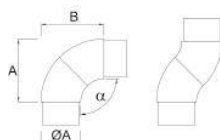

CO.SA402(X)

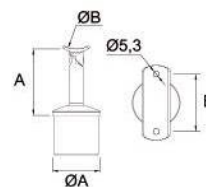

CO.SA404(X)

	ØA (MM)	ØB (MM)	A (MM)	B (MM)	α (MM)
CO.SA4004	20	43	28	48	-
CO.SA4005	20	50.8	28	48	-
CO.SA4024	43	-	65	65	90-180
CO.SA4025	50.8	-	78	78	90-180
CO.SA40433	38.1	38.1	55	48	-
CO.SA40435	38.1	50.8	55	48	-
CO.SA4044	43	43	60	52	-
CO.SA4045	50.8	50.8	65	60	-

224

✓ Acabamento satinado sob consulta  
Satin finish under request

## BASES EM INOX AISI-316 POLIDO PARA FIXAÇÃO POLISHED AISI-316 STAINLESS STEEL BASES FOR FIXATION

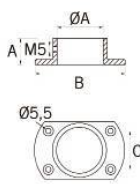

CO.AV600(X)

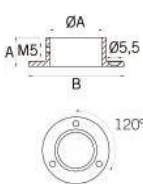

CO.AV601(X)

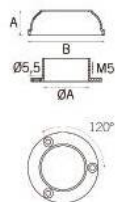

CO.AV602(X)

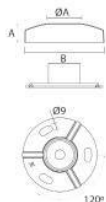

CO.AV603(X)

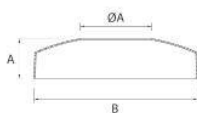

CO.AV650(X)



	ØA (MM)	A (MM)	B (MM)	C (MM)
CO.AV6003	38.1	34	75	28
CO.AV6004	43	35	85	34
CO.AV6005	50.8	36	96	39
CO.AV6013	38.1	24	75	-
CO.AV6014	43	25	80	-
CO.AV6015	50.8	31	102	-
CO.AV6023	38.1	25	73	-
CO.AV6024	43	26	82	-
CO.AV6025	50.8	29	85	-
CO.AV6033	38.1	22.5	99	-
CO.AV6034	43	22.5	99	-
CO.AV6035	50.8	22.5	99	-
CO.AV6502	20	11.5	55	-
CO.AV6503	38.1	22.5	99	-
CO.AV6504	43	22.5	99	-
CO.AV6505	50.8	22.5	99	-
CO.AV6506	63.5	24	110	-



**LIGAÇÕES EM INOX AISI-316 POLIDO**  
**POLISHED AISI-316 STAINLESS STEEL CONNECTIONS**

✓ Para tubo de 1,5mm espessura  
 For 1,5mm tube thickness

✓ Acabamento satinado sob consulta  
 Satin finish under request

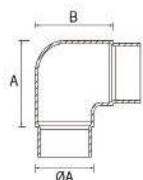

CO.CT200(X)

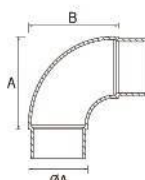

CO.CT201(X)

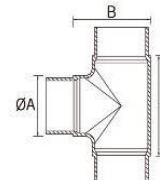

CO.CT202(X)

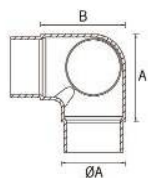

CO.CT205(X)

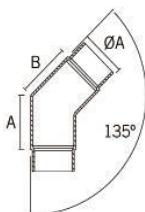

CO.CT206(X)

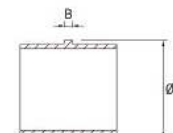

CO.CT207(X)



	<b>ØA</b> (MM)	<b>A</b> (MM)	<b>B</b> (MM)
CO.CT2004	43	55	55
CO.CT2005	50.8	60	60
CO.CT2012	20	30	30
CO.CT2014	43	55	55
CO.CT2015	50.8	60	60
CO.CT2024	43	71	57
CO.CT2025	50.8	69	60
CO.CT2054	43	55	55
CO.CT2055	50.8	60	60
CO.CT2064	43	50	55
CO.CT2065	50.8	50	60
CO.CT2071	12	-	2
CO.CT2072	20	-	4
CO.CT2073	38.1	-	4
CO.CT2074	43	-	4
CO.CT2075	50.8	-	4
CO.CT2083	38.1	83	75
CO.CT2084	43	90	80
CO.CT2085	50.8	95	102

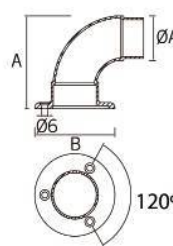

CO.CT208(X)





## REMATES EM INOX AISI-316 POLIDO POLISHED AISI-316 STAINLESS STEEL TRIMS

✓ Para tubo de 1,5mm espessura  
For 1,5mm tube thickness

✓ Acabamento satinado sob consulta  
Satin finish under request

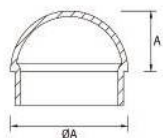

CO.TF501(X)

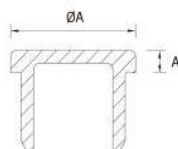

CO.TF502(X)

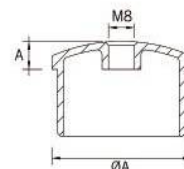

CO.TF503(X)

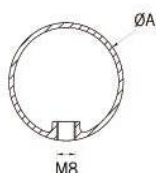

CO.TF504(X)

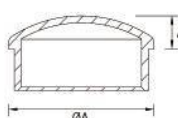

CO.TF505(X)

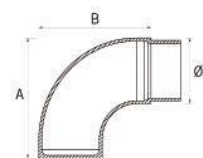

CO.TF5065(X)

226

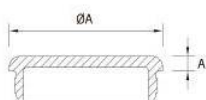

CO.TF507(X)

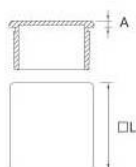

CO.TF530

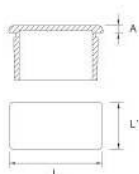

CO.TF535



	ØA (MM)	A (MM)	B (MM)	L (MM)	L' (MM)
CO.TF5013	38.1	19.5	-	-	-
CO.TF5014	43	21.5	-	-	-
CO.TF5015	50.8	25	-	-	-
CO.TF50212	12	2	-	-	-
CO.TF50215	15	2	-	-	-
CO.TF50218	18	2	-	-	-
CO.TF50220	20	2	-	-	-
CO.TF50225	25	2	-	-	-
CO.TF50230	30	2	-	-	-
CO.TF50233	33	2	-	-	-
CO.TF5023	38.1	2	-	-	-
CO.TF50240	40	2	-	-	-
CO.TF5024	43	2	-	-	-
CO.TF5025	50.8	2	-	-	-
CO.TF5026	63.5	2	-	-	-
CO.TF5034	43	8.4	-	-	-
CO.TF5035	50.8	8.4	-	-	-
CO.TF5045	50	-	-	-	-
CO.TF5047	70	-	-	-	-
CO.TF5053	-	-	-	-	-
CO.TF5054	-	-	-	-	-
CO.TF5055	-	-	-	-	-
CO.TF5065	50.8	83	80	80	80
CO.TF5074	43	4	-	-	-
CO.TF5075	50.8	4	-	-	-
CO.TF53030	-	3	-	30X40	-
CO.TF53040	-	3	-	40X40	-
CO.TF53520	-	3	-	20	10
CO.TF53540	-	3	-	40	20



**SUPORTES EM INOX AISI-316 POLIDO**  
**POLISHED AISI-316 STAINLESS STEEL SUPPORTS**

☑ Acabamento satinado sob consulta  
 Satin finish under request

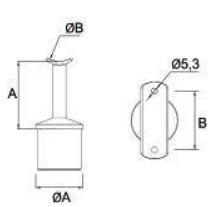

CO.ST302(X)

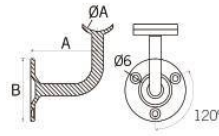

CO.ST303(X)

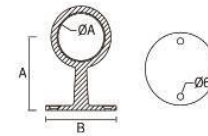

CO.ST304(X)

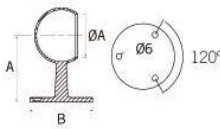

CO.ST305(X)

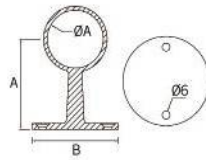

CO.ST306(X)

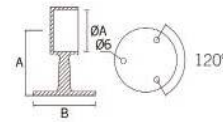

CO.ST307(X)



	ØA (MM)	ØB (MM)	A (MM)	B (MM)
CO.ST30233	38.1	38.1	55	48
CO.ST30235	38.1	50.8	55	48
CO.ST3024	43	43	60	52
CO.ST3025	50.8	50.8	65	60
CO.ST3034	43	-	70	63
CO.ST3035	50.8	-	70	63
CO.ST3043	38.1	-	69	57
CO.ST3044	43	-	68	67
CO.ST3045	50.8	-	78	80
CO.ST3053	38.1	-	69	57
CO.ST3054	43	-	68	67
CO.ST3055	50.8	-	78	80
CO.ST3064	43	-	72	69
CO.ST3065	50.8	-	83	63
CO.ST3074	43	-	72	69
CO.ST3075	50.8	-	83	63
CO.ST3082	20	-	4	-
CO.ST30924	20	43	4	-
CO.ST30925	20	50.8	4	-
CO.ST30933	38.1	38.1	17	-
CO.ST30935	38.1	50.8	9	-
CO.ST30944	43	43	12	-
CO.ST30955	50.8	50.8	9	-
CO.ST31024	20	43	4	-
CO.ST31025	20	50.8	4	-
CO.ST31033	38.1	38.1	5	-
CO.ST31035	38.1	50.8	5	-
CO.ST31044	43	43	5	-
CO.ST31055	50.8	50.8	5	-

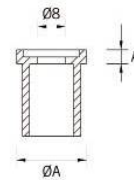

CO.ST3082

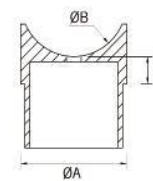

CO.ST309(X)

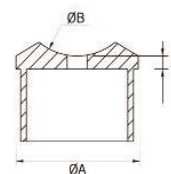

CO.ST310(X)





**SUPORTES EM INOX AISI-316 POLIDO**  
**POLISHED AISI-316 STAINLESS STEEL SUPPORTS**

☑ Acabamento satinado sob consulta  
*Satin finish under request*

☑ \* Indicar se direita ou esquerda no pedido  
*\* Indicate if right or left when ordering*

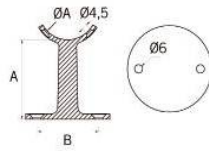

CO.ST311(X)

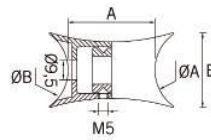

CO.ST312(X)

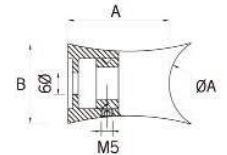

CO.ST313(X)

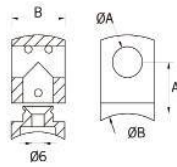

CO.ST320(X)

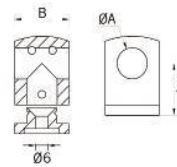

CO.ST321(X)

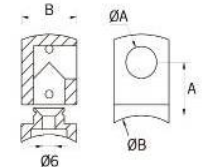

CO.ST322(X)

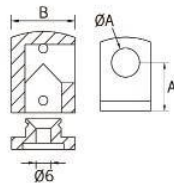

CO.ST323(X)

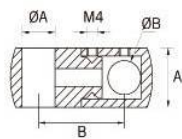

CO.ST324

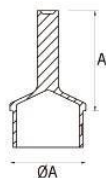

CO.ST330(X)

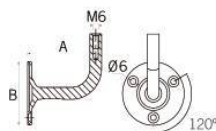

CO.ST351



	ØA (MM)	ØB (MM)	A (MM)	B (MM)
CO.ST3114	43	-	57	62.5
CO.ST3115	50.8	-	57	62.5
CO.ST3124	43	43	44	37
CO.ST3125	50.8	50.8	44	37
CO.ST313	40	-	44	34
CO.ST32024	12	43	20	21
CO.ST32025	12	50.8	20	21
CO.ST32044	14	43	21	23
CO.ST32045	14	50.8	21	23
CO.ST32064	16	43	25	26
CO.ST32065	16	50.8	25	26
CO.ST32004	20	43	25	30
CO.ST32005	20	50.8	25	30
CO.ST32122	12	-	20	21
CO.ST32142	14	-	21	23
CO.ST32162	16	-	25	26
CO.ST32102	20	-	25	30
CO.ST32224 *	12	43	20	21
CO.ST32225 *	12	50.8	20	21
CO.ST32264 *	16	43	25	23
CO.ST32265 *	16	50.8	25	23
CO.ST32204 *	20	43	25	30
CO.ST32205 *	20	50.8	25	30
CO.ST32322 *	12	-	20	21
CO.ST32362 *	16	-	25	26
CO.ST32302 *	20	-	25	30
CO.ST324	12	12	21	25
CO.ST3303	38.1	-	55	-
CO.ST3304	43	-	55	-
CO.ST3305	50.8	-	55	-
CO.ST351	-	-	70	63



**CLIPS EM INOX AISI-316 POLIDO PARA VIDRO**  
**POLISHED AISI-316 STAINLESS STEEL CLIPS FOR GLASS**

☑ Acabamento satinado sob consulta  
 Satin finish under request

☑ \* Indicar se direita ou esquerda no pedido  
 \* Indicate if right or left when ordering

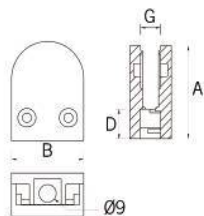

CO.CC700(X)

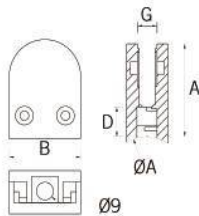

CO.CC701(X)

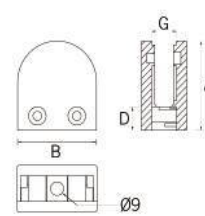

CO.CC702(X)

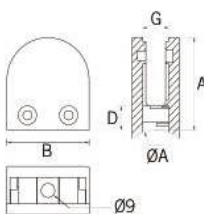

CO.CC703(X)

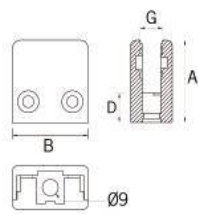

CO.CC720

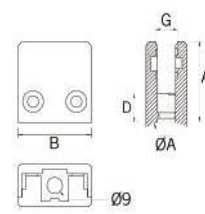

CO.CC721(X)



	ØA (MM)	A (MM)	B (MM)	D (MM)	G (MM)
CO.CC7000	-	50	40	16	6-8
CO.CC7001	-	50	40	16	8-10
CO.CC70136	38.1	50	40	16	6-8
CO.CC70146	43	50	40	16	6-8
CO.CC70156	50.8	50	40	16	6-8
CO.CC70148	43	50	40	16	8-10
CO.CC70158	50.8	50	40	16	8-10
CO.CC701510	50.8	50	40	16	10-12
CO.CC701410	43	50	40	16	10-12
CO.CC702	-	60	55	15.5	10-12
CO.CC70331	38.1	60	55	15.5	10-12
CO.CC70341	43	60	55	15.5	10-12
CO.CC70351	50.8	60	55	15.5	10-12
CO.CC7200	-	45	45	16	8-10
CO.CC72148	43	45	45	16	8-10
CO.CC72158	50.8	45	45	16	8-10
CO.CC75056 *	-	50	40	16	6-8
CO.CC75058 *	-	50	40	16	8-10
CO.CC75146 *	43	50	40	16	6-8
CO.CC75156 *	50.8	50	40	16	6-8
CO.CC75148 *	43	50	40	16	8-10
CO.CC75158 *	50.8	50	40	16	8-10

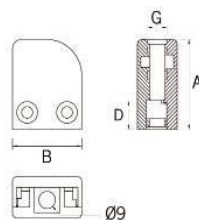

CO.CC750(X)

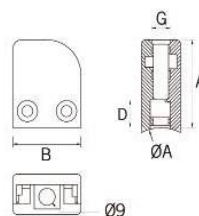

CO.CC751(X)





AC.1560

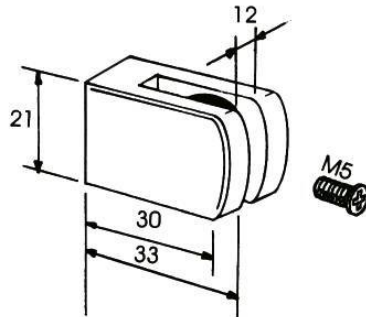

AC.1561

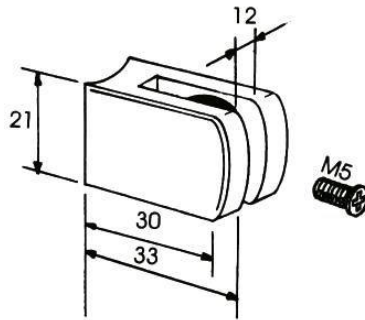

AC.1562 - AC.1564

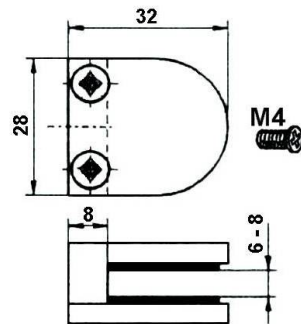

AC.1563 - AC.1565

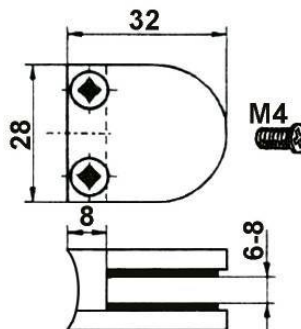

## AC.1560 - AC.1565

Clip em inox AISI 316 para superfícies planas e tubo redondo

*AISI 316 stainless steel clip for flat surfaces and round tube*

	Ø TUBO (MM) Ø TUBE (MM)	VIDRO (MM) GLASS (MM)
AC.1560	-	4-10
AC.1561	30	4-10
AC.1562	-	6
AC.1563	30	6
AC.1564	-	8
AC.1565	30	8

## EMBELEZADORES LISOS EM INOX AISI-304 AISI-316 STAINLESS STEEL PLAIN COVERS

### SEM FURO *WITHOUT HOLE*

	A (MM)	B (MM)	C (MM)
MI.LGC	110	15	-
MI.LPC	67	12	-

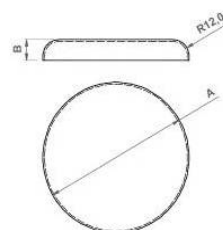

### PARA TUBO REDONDO *FOR ROUND TUBE*

	A (MM)	B (MM)	C (MM)
MI.LGT30	110	15	30
MI.LGT35	110	15	35
MI.LGT38	110	15	38
MI.LGT40	110	15	40
MI.LGT43	110	15	43
MI.LGT50	110	15	50
MI.LGT53	110	15	53
MI.LGT63	110	15	63
MI.LPT12	67	12	12
MI.LPT16	67	12	16
MI.LPT18	67	12	18
MI.LPT20	67	12	20
MI.LPT25	67	12	25
MI.LPT28	67	12	28

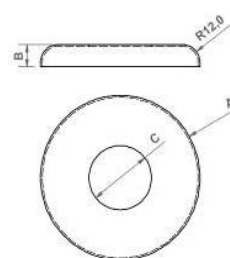

### PARA TUBO QUADRADO *FOR SQUARE TUBE*

	A (MM)	B (MM)	C (MM)
MI.LGT4040	110	15	40
MI.LGT3030	110	15	30

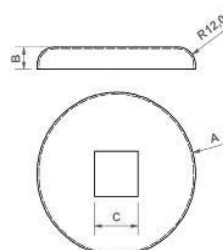

### PARA TUBO E BARRA RETANGULAR FOR RECTANGULAR TUBE AND BAR

	A (MM)	B (MM)	C (MM)	D (MM)
MI.LGT4020	110	15	40	20
MI.LGP4	110	15	40	8-10
MI.LPG5	110	15	50	8-10

